

公司简介

绵阳久银流体自动化控制设备有限公司于 2019 年在（中国科技城）建设有一个拥有 8000 平米生产工厂。公司有销售团队、研发技术团队，引进美国总部技术、管理方案在绵阳成立生产及研发基地。以满足半导体行业和生物制药行业对流体控制系统产品高洁净度的要求，公司拥有世界一流的精密 CNC 加工设备，自动焊接设备、高压气密实验设备和爆破实验设备、光谱分析设备、硬度测试等设备。

产品主要有：高端管阀件、实验室气体系统、制药流体连接系统、过滤器、减压阀、气体隔膜阀、气体波纹管阀、卫生级隔膜阀、卫生级球阀、特殊合金阀门、金属软管、半导体特气控制设备、化学品输送设备、取样控制系统、气体控制阀和手动阀等产品。

产品主要运用在：CNG/LNG 汽车、氢能汽车配件、半导体、工业气体、制药、电子特气、水处理，石油化工等领域。公司拥有员工 200 余人，拥有 30 余人的销售和售后服务团队，遍布于全国各地办事处为客户提供最安全的产品和最好的服务，公司的使命是为全球领先的管阀件事业奋斗和为国内、外管阀件的安全做出贡献。

诚信！

创新！

自律！

和谐！



产品广泛的应用领域



CNG/LNG 汽车工程



电子特气气体工程



海上平台工程



天然气输送工程



电力工程



石油/石化/炼化工程

J-LOK

绵阳久银流体自动化控制设备有限公司

目 录

直通中间接头 Union -JU		1
直通中间接头 Reducing Union -JRU		2-3
堵头 Plug-JP		3
直通穿板接头 Bulkhead Union -JBU		4-5
堵头 Gcp-JC		4
直通终端接头 Male Connector-JMC		6
直通终端接头 Male Connector-JMC		7
直通终端接头 Male Connector-JMC		7-8
端口接头 PC Port Connector-JCP		8
45 度弯头终端 45 Male Elbow-JL45M		9
直通穿板终端 Bulkhead Male Connector-JMCB-N 11		10
直通卡套管接头 Reducer-JR		11
直通穿板卡套管接头 Bulkhead Adapter-JRB		11-12
直通内丝卡套管接头 Female Connector-JCF		12
直通穿板内丝卡套管接头 Bulkhead Female Connector -JCFB		13
直通外丝卡套管接头 Male Adapter-JAM		14
直通内丝卡套管接头 Female Adapter-JAF		15
直角中间接头 Union Elbow -JL Reducing Union Elbow-JRL		16
直角终端接头 Male Elbow-JLMC		17-18
直角可调接头 Positionable SAE Male Elbow JL-OG		18
直角卡套对焊接头 Male Pipe Weld Elbow-JLCW		19

直角内丝卡套接头		19
NPT (F) Threaded Elbow-JLCF		
三通中间接头		20
Union Tee -JT		
四通中间接头		20
Union Cross -JX		
三通变径接头		21
Reducing Union Tee -JTR		
三通终端卡套接头		22
Male Run Tee -JTTM		
三通终端卡套接头		22
Male Branch Tee-JTMT		
三通内丝卡套接头		23
NPT (F) Threaded Tee-JTTF		
三通内丝卡套接头		23
NPT (F) Threaded Tee-JTFT		
法兰转卡套接头		24
J-LOK Flanges ASME/ANSI B16.5 30		
螺母		25
Nut-JN		
前卡套		25
Front Ferrule-JFF		
后卡套		25
Back Ferrule-JFB		
撑管		25
Tube Insert-JI		
J-LOK VCR 接头系列 Metal GasketFace		26
SealFittings		
Male Nut 公螺母		26
Female Nut 母螺母		26
Gasket Retainer 自定中心垫片		26
Assembly		
Silver Plated		26
Nonretained 平面自由垫片		
Plug 堵头		26
Cap 堵头		26
Long Gland 加长焊管本体		27
Long Gland L 加长变径焊管本体		27
Male NPT Connector 外丝转 VCR		27
JVCR-N-V		
J-LOK Tube Fitting ConnectorVCR 外丝转卡套		27
JVCR-T-V		

微焊接系列接头 WELD FITTINGS		28
Micro-R-union JBW		28
Micro Elbow JLBW		28
Micro Tee JTBW		28
Long Reducing Union JBW-L		28
Long Tee JBWT-L		29
Long Elbow JBWL-L		29
Long Reducing Tee JBWTR-T		29
J-LOK 快速接头系列 Quick Connect series		30
钢瓶接头系列 G5/8 /W21.8		31
钢瓶接头系列 CGA/DIN/JIS		32-37
金属垫片/组合垫片		38
无缝钢管 Tube 管系列		39
无缝钢管 Pipe 管系列 美制/公制尺寸表		40-41

直通中间接头

Union JU

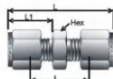

Ordering Number	Tube OD	Dimensions-Inch			
		L	L1	I	HEX
JU1T	1/16"	0.99	0.43	0.69	5/16
JU2T	1/8"	1.39	0.6	0.88	7/16
JU3T	3/16"	1.48	0.64	0.95	7/16
JU4T	1/4"	1.62	0.7	1.03	1/2
JU5T	5/16"	1.70	0.73	1.11	9/16
JU6T	3/8"	1.77	0.76	1.19	5/8
JU8T	1/2"	2.02	0.87	1.22	13/16
JU10T	5/8"	2.05	0.87	1.25	15/16
JU12T	3/4"	2.11	0.87	1.31	1-1/16
JU14T	7/8"	2.18	0.87	1.38	1-3/16
JU16T	1"	2.57	1.05	1.59	1-3/8
JU20T	1-1/4"	3.61	1.52	1.89	1-3/4
JU24T	1-1/2"	4.23	1.77	2.11	2-1/8
JU32T	2"	5.88	2.47	2.94	2-3/4

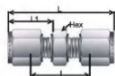

Ordering Number	Tube OD	Dimensions-MM			
		L	L1	I	HEX
JU2M	2	35.6	15.3	22.4	12.0
JU3M	3	35.3	15.3	22.1	12.0
JU4M	4	37.4	16.1	24.2	12.0
JU6M	6	41.2	17.7	26.2	14.0
JU8M	8	43.2	18.6	28.2	15.0
JU10M	10	46.2	19.5	31.0	18.0
JU12M	12	51.2	22.0	31.0	22.0
JU14M	14	52.0	22.0	31.8	24.0
JU15M	15	52.0	22.0	31.8	24.0
JU16M	16	52.0	22.0	31.8	27.0
JU18M	18	53.5	22.0	33.3	30.0
JU20M	20	55.0	22.0	34.8	30.0
JU22M	22	55.0	22.0	34.8	35.0
JU25M	25	65.1	26.5	40.5	

直通变径中间
Reducing Union JRU

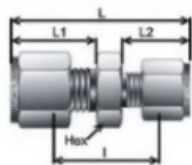

Ordering Number	Dimensions-Inch						
	T1 Tube OD	T12Tube OD	L	L1	L2	I	HEX
JRU2T1T	1/8	1/16	1.21	0.6	0.43	0.81	7/16
JRU3T1T	3/16	1/16	1.27	0.64	0.43	0.86	7/16
JRU3T2T	3/16	1/8	1.44	0.64	0.6	0.92	7/16
JRU4T1T	1/4	1/16	1.38	0.7	0.43	0.91	1/2
JRU4T2T	1/4	1/8	1.52	0.7	0.60	0.97	1/2
JRU4T3T	1/4	3/16	1.55	0.7	0.64	1.00	1/2
JRU5T2T	5/16	1/8	1.58	0.73	0.60	1.03	9/16
JRU5T4T	5/16	1/4	1.67	0.73	0.70	1.08	9/16
JRU6T1T	3/8	1/16	1.44	0.76	0.43	1.00	5/8
JRU6T2T	3/8	1/8	1.61	0.76	0.60	1.06	5/8
JRU6T4T	3/8	1/4	1.71	0.76	0.70	1.13	5/8
JRU6T5T	3/8	5/16	1.75	0.76	0.73	1.16	5/8
JRU8T2T	1/2	1/8	1.75	0.87	0.6	1.09	13/16
JRU8T4T	1/2	1/4	1.85	0.87	0.7	1.16	13/16
JRU8T6T	1/2	3/8	1.91	0.87	0.76	1.22	13/16
JRU10T6T	5/8	3/8	1.94	0.87	0.76	1.25	13/16
JRU10T8T	5/8	1/2	2.05	0.87	0.87	1.25	15/16
JRU12T4T	3/4	1/4	1.95	0.87	0.76	1.25	1-1/16
JRU12T6T	3/4	3/8	2.00	0.87	0.76	1.31	1-1/16
JRU12T8T	3/4	1/2	2.11	0.87	0.87	1.31	1-1/16
JRU12T10T	3/4	5/8	2.11	0.87	0.87	1.31	1-1/16
JRU16T8T	1	1/2	2.39	1.05	0.87	1.5	1-3/8
JRU16T12T	1	3/4	2.39	1.05	0.87	1.5	1-3/8

直通变径中接头
Reducing Union JRU

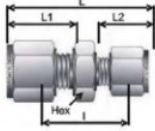

Ordering Number	Dimensions-MM						
	T1 Tube OD	T12Tube OD	L	L1	L2	I	HEX
JRU3M3M	3	2	35.8	15.3	15.3	22.6	12.0
JRU6M2M	6	2	38.7	17.7	15.3	24.6	14.0
JRU6M3M	6	3	38.7	17.7	15.3	24.6	14.0
JRU6M4M	6	4	39.5	17.7	16.1	25.4	14.0
JRU8M6M	8	6	42.4	18.6	17.7	27.4	15.0
JRU10M6M	10	6	44.5	19.5	17.7	29.4	18.0
JRU10M8M	10	8	44.5	19.5	18.6	29.4	18.0
JRU12M6M	12	6	47.0	22.0	17.7	29.4	22.0
JRU12M8M	12	8	47.8	22.0	18.6	30.2	22.0
JRU12M10M	12	10	48.7	22.0	19.5	31.0	22.0
JRU16M10M	16	10	49.5	22.0	19.5	31.8	24.0
JRU16M12M	16	12	52.0	22.0	22.0	31.8	24.0
JRU18M12M	18	12	53.5	22.0	22.0	33.3	27.0
JRU25M18M	25	18	60.5	26.5	22.0	38.1	35.0
JRU25M20M	25	20	52.3	26.5	22.0	39.9	35.0

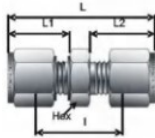

Ordering Number	Dimensions-MM						
	T1 Tube OD	T12Tube OD	L	L1	L2	I	HEX
JRU3M2T	3	1/8	36.3	15.3	15.3	22.6	12.0
JRU4M2T	4	1/8	36.5	16.1	15.3	23.6	12.0
JRU4M4T	4	1/4	39.3	16.1	17.7	26.4	14.0
JRU6M2T	6	1/8	38.5	17.7	15.3	24.6	14.0
JRU6M4T	6	1/4	41.1	17.7	17.7	25.9	14.0
JRU6M5T	6	5/16	42.3	17.7	18.8	27.2	14.0
JRU8M4T	8	1/4	42.3	18.6	17.7	27.2	15.0
JRU8M6T	8	3/8	44.0	18.6	19.3	29.1	15.0
JRU10M2T	10	1/8	41.8	19.5	15.3	27.9	18.0
JRU10M4T	10	1/4	44.5	19.5	17.7	29.2	18.0
JRU10M6T	10	3/8	46.0	19.5	19.3	30.7	18.0
JRU12M6T	12	3/8	48.4	22.0	19.3	30.7	22.0
JRU12M8T	12	1/2	51.1	22.0	21.8	31.0	22.0
JRU15M8T	15	1/2	52.0	22.0	21.8	32.0	24.0
JRU16M16T	16	3/8	52.0	22.0	19.3	34.3	24.0
JRU18M12T	18	3/4	53.5	22.0	21.6	33.5	27.0

堵头
Plug JP



Ordering Number	Tube OD	Dimensions-Inch		
		L	Thread	HEX
JP1T	1/16	0.31	10-32	5/16
JP2T	1/8	0.47	5/16-20	7/16
JP3T	3/16	0.47	3/8-20	1/2
JP4T	1/4	0.50	7/16-20	9/16
JP5T	5/16	0.53	1/2-20	5/8
JP6T	3/8	0.56	9/16-20	11/16
JP8T	1/2	0.69	3/4-20	7/8
JP10T	5/8	0.69	7/8-20	1
JP12T	3/4	0.69	1-20	1-1/8
JP14T	7/8	0.69	1-1/8-20	1-1/4
JP16T	1	0.81	1-5/16-20	1-1/2
JP20T	1-1/4	1.35	1-5/8-20	1-7/8
JP24T	1-1/2	1.72	1-15/16-20	2-1/4
JP32T	2	2.27	2-5/8-20	3



Ordering Number	Tube OD	Dimensions-MM		
		L	Thread	HEX
JP2M-P	2	11.9	5/16-20	12.0
JP3M-P	3	11.9	5/16-20	12.0
JP4M-P	4	11.9	3/8-20	12.0
JP6M-P	6	12.7	7/16-20	14.0
JP8M-P	8	13.5	1/2-20	15.0
JP10M-P	10	15.1	5/8-20	18.0
JP12M-P	12	17.5	3/4-20	22.0
JP14M-P	14	17.5	7/8-20	24.0
JP15M-P	15	17.5	7/8-20	24.0
JP16M-P	16	17.5	7/8-20	24.0
JP18M-P	18	17.5	1-20	27.0
JP20M-P	20	17.5	1-1/8-20	30.0
JP22M-P	22	17.5	1-1/8-20	30.0
JP25M-P	25	20.6	1-5/8-20	35.0

直通穿板中间接头
Bulkhead Union
JBU

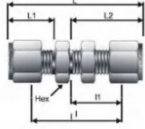

Ordering Number	Dimensions-Inch							Panel Hole Size	Max, Panel Thickness
	Tube OD	L	L1	L2	I	I1	HEX		
JBU1T	1/16	1.23	0.43	0.68	0.94	0.53	5/16	13/64	1/8
JBU2T	1/8	2.02	0.60	1.23	1.50	0.97	1/2	21/64	1/2
JBU3T	3/16	2.11	0.64	1.26	1.59	1.00	9/16	25/64	1/2
JBU4T	1/4	2.27	0.70	1.31	1.69	1.02	5/8	29/64	17/32
JBU5T	5/16	2.40	0.73	1.42	1.81	1.12	11/16	33/64	9/16
JBU6T	3/8	2.46	0.76	1.44	1.88	1.15	3/4	37/64	9/16
JBU8T	1/2	2.80	0.87	1.65	2.00	1.25	15/16	49/64	19/32
JBU10T	5/8	2.86	0.87	1.68	2.06	1.28	1-1/16	57/64	19/32
JBU12T	3/4	3.11	0.87	1.87	2.31	1.47	1-3/16	1-1/64	25/32
JBU14T	7/8	3.33	0.87	2.09	2.53	1.69	1-3/8	1-9/64	15/16
JBU16T	1	3.78	1.05	2.27	2.81	1.78	1-5/8	1-21/64	15/16

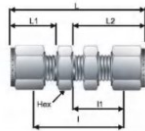

Ordering Number	Dimensions-MM							Panel Hole Size	Max, Panel Thickness
	Tube OD	L	L1	L2	I	I1	HEX		
JBU3M	3	51.3	15.3	31.2	38.2	24.6	14.0	8.3	12.7
JBU4M	4	53.7	16.1	32.0	40.5	25.4	14.0	9.9	12.7
JBU6M	6	57.9	17.7	33.7	42.9	26.2	16.0	11.5	10.2
JBU8M	8	61.0	18.6	36.0	46.0	28.5	18.0	13.1	11.2
JBU10M	10	63.6	19.5	37.0	48.4	29.4	22.0	16.3	11.2
JBU12M	12	71.0	22.0	41.9	50.8	31.8	24.0	19.5	1.7
JBU15M	15	72.5	22.0	42.6	52.3	32.5	27.0	22.5	12.7
JBU16M	16	72.6	22.0	42.6	52.4	32.5	27.0	22.5	12.7
JBU18M	18	78.9	22.0	47.4	58.7	37.3	30.0	26.0	16.8
JBU20M	20	88.2	22.0	51.0	68.0	40.9	35.0	29.0	19.0
JBU25M	25	95.8	26.5	54.4	71.4	42.2	41.0	33.8	24.0

堵头
Gcp JC

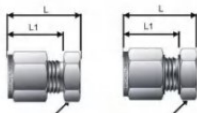

Ordering Number	Tube OD	Dimensions-Inch		
		L	L1	HEX
JC1T	1/16	0.56	0.43	5/16
JC2T	1/8	0.79	0.60	7/16
JC3T	3/16	0.84	0.64	7/16
JC4T	1/4	0.92	0.70	1/2
JC5T	5/16	0.96	0.73	9/16
JC6T	3/8	1.01	0.76	5/8
JC8T	1/2	1.15	0.87	13/16
JC10T	5/8	1.18	0.87	15/16
JC12T	3/4	1.25	0.87	1-3/16
JC14T	7/8	1.31	0.87	1-3/16
JC16T	1	1.52	1.05	1-3/8
JC20T	1-1/4	2.09	1.52	1-3/4
JC24T	1-1/2	2.53	1.77	2-1/8
JC32T	2	3.41	2.47	2-3/4

Ordering Number	Tube OD	Dimensions-Inch		
		L	L1	HEX
JC2M	2	13.5	15.3	12.0
JC3M	3	13.5	15.3	12.0
JC4M	4	14.3	16.1	12.0
JC6M	6	15.9	17.7	14.0
JC8M	8	17.1	18.6	15.0
JC10M	10	19.1	19.5	18.0
JC12M	12	19.1	22.0	22.0
JC14M	14	19.8	22.0	24.0
JC15M	15	19.8	22.0	24.0
JC16M	16	19.8	22.0	24.0
JC18M	18	21.3	22.0	27.0
JC20M	20	23.9	22.0	30.0
JC22M	22	23.9	22.0	30.0
JC25M	25	26.2	26.5	35.0

直通终端接头
Male Connector JMC

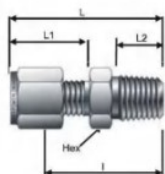

Ordering Number	Dimensions-Inch						
	Tube OD	NPT Pipe Threaded	L	L1	L2	I	HEX
JMC1T2N	1/16	1/8	1.03	0.43	0.38	0.88	7/16
JMC1T4N	1/4	1/4	1.23	0.43	0.56	1.08	9/16
JMC2T2N	1/8	1/8	1.20	0.60	0.38	0.94	7/16
JMC2T4N	1/8	1/4	1.40	0.60	0.56	1.14	9/16
JMC2T6N	1/8	3/8	1.42	0.60	0.56	1.16	11/16
JMC2T8N	1/8	1/2	1.67	0.60	0.75	1.41	7/8
JMC3T2N	3/16	1/8	1.23	0.64	0.38	0.97	7/16
JMC3T4N	3/16	1/4	1.43	0.64	0.56	1.17	9/16
JMC4T2N	1/4	1/8	1.29	0.70	0.38	1.00	1/2
JMC4T4N	1/4	1/4	1.49	0.70	0.56	1.20	9/16
JMC4T6N	1/4	3/8	1.51	0.70	0.56	1.22	11/16
JMC4T8N	1/4	1/2	1.76	0.70	0.75	1.47	7/8
JMC5T2N	5/16	1/8	1.34	0.73	0.38	1.05	9/16
JMC5T4N	5/16	1/4	1.52	0.73	0.56	1.23	9/16
JMC5T6N	5/16	3/8	1.55	0.73	0.56	1.25	11/16
JMC5T8N	5/16	1/2	1.79	0.73	0.75	1.50	7/8
JMC6T2N	3/8	1/8	1.38	0.76	0.38	1.09	5/8
JMC6T4N	3/8	1/4	1.57	0.76	0.56	1.28	5/8
JMC6T6N	3/8	3/8	1.57	0.76	0.56	1.28	11/16
JMC6T8N	3/8	1/2	1.82	0.76	0.75	1.53	7/8
JMC6T12N	3/8	3/4	1.88	0.76	0.75	1.59	1-1/16
JMC8T2N	1/2	1/8	1.53	0.87	0.38	1.13	13/16
JMC8T4N	1/2	1/4	1.71	0.87	0.56	1.31	13/16
JMC8T6N	1/2	3/8	1.71	0.87	0.56	1.31	13/16
JMC8T8N	1/2	1/2	1.93	0.87	0.75	1.53	7/8
JMC8T12N	1/2	3/4	1.99	0.87	0.75	1.59	1-1/16
JMC8T16N	1/2	1	2.28	0.87	0.94	1.88	1-3/8
JMC10T6N	5/8	3/8	1.74	0.87	0.56	1.34	15/16
JMC10T8N	5/8	1/2	1.93	0.87	0.75	1.53	15/16
JMC10T12N	5/8	3/4	1.99	0.87	0.75	1.59	1-1/16
JMC12T8N	3/4	1	1.99	0.87	0.75	1.59	1-1/16
JMC12T12N	3/4	3/4	1.99	0.87	0.75	1.59	1-1/16
JMC12T16N	3/4	1	2.28	0.87	0.94	1.88	1-3/8
JMC14T12N	7/8	3/4	1.99	0.87	0.75	1.59	1-3/16
JMC14T16N	7/8	1	2.28	0.87	0.94	1.88	1-3/8
JMC16T8N	1	1/2	2.27	0.75	0.75	1.78	1-3/8
JMC16T12N	1	3/4	2.27	1.05	0.75	1.78	1-3/8
JMC16T16N	1	1	2.46	1.05	0.94	1.97	1-3/8
JMC20T20N	1-1/4	1-1/4	3.03	1.52	0.97	2.17	1-3/4
JMC24T24N	1-1/2	1-1/2	3.50	1.77	1.00	2.44	2-1/8
JMC32T32N	2	2	4.47	2.47	1.04	3.00	2-3/4

Ordering Number	Dimensions-MM						
	Tube OD	NPT Pipe Threaded	L. 1	L1	L2	I	HEX
JMC2T2R	1/8	1/8	1.20	0.60	0.38	0.94	7/16
JMC2T4R	1/8	1/4	1.40	0.60	0.56	1.14	9/16
JMC4T2R	1/4	1/8	1.30	0.70	0.38	1.00	1/2
JMC4T4R	1/4	1/4	1.52	0.70	0.65	1.20	9/16
JMC4T6R	1/4	3/8	1.52	0.70	0.56	1.22	11/16
JMC4T8R	1/4	1/2	1.77	0.70	0.75	1.47	7/8
JMC5T2R	5/16	1/8	1.34	0.73	0.38	1.05	9/16
JMC5T4R	5/16	1/4	1.52	0.73	0.56	1.23	9/16
JMC6T2R	3/8	1/8	1.39	0.76	0.38	1.09	5/8
JMC6T4R	3/8	1/4	1.57	0.76	0.56	1.28	5/8
JMC6T6R	3/8	3/8	1.57	0.76	0.56	1.28	11/16
JMC6T8R	3/8	1/2	1.82	0.76	0.75	1.53	7/8
JMC8T4R	1/2	1/4	1.69	0.86	0.56	1.31	13/16
JMC8T6R	1/2	3/8	1.69	0.86	0.56	1.31	13/16
JMC8T8R	1/2	1/2	1.91	0.86	0.75	1.53	7/8

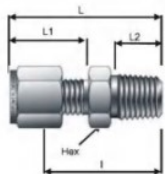

直通终端接头
Male Connector JMC

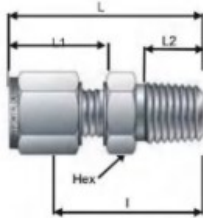

Ordering Number	Dimensions-Inch						
	Tube OD	NPT Pipe Threaded	L. 1	L1	L2	I	HEX
JMC2M2N	2	1/8	29.7	15.3	9.5	23.1	12.0
JMC3M2N	3	1/8	29.7	15.3	9.5	23.1	12.0
JMC3M4N	3	1/4	35.3	15.3	14.3	28.7	14.0
JMC4M2N	4	1/8	31.2	16.1	9.5	24.6	12.0
JMC4M4N	4	1/4	36.3	16.1	14.3	29.7	14.0
JMC6M2N	6	1/8	32.9	17.7	9.5	25.4	14.0
JMC6M4N	6	1/4	38.1	17.7	14.3	30.6	14.0
JMC6M6N	6	3/8	38.5	17.7	14.3	31.0	18.0
JMC6M8N	6	1/2	44.8	17.7	19.1	37.3	22.0
JMC8M2N	8	1/8	34.2	18.6	9.5	26.7	15.0
JMC8M4N	8	1/4	38.8	18.6	14.3	31.3	15.0
JMC8M6N	8	3/8	39.3	18.6	14.3	31.8	18.0
JMC8M8N	8	1/2	45.6	18.6	19.1	38.1	22.0
JMC10M2N	10	1/8	36.1	19.5	9.5	28.6	18.0
JMC10M4N	10	1/4	40.9	19.5	14.3	33.3	18.0
JMC10M6N	10	3/8	40.9	19.5	14.3	33.3	18.0
JMC10M8N	10	1/2	47.5	19.5	19.1	38.9	22.0
JMC10M12N	10	3/4	46.4	19.5	19.1	38.9	27.0
JMC10M16N	10	1	55.0	19.5	23.8	47.5	35.0
JMC12M4N	12	1/4	43.4	22.0	14.3	33.3	22.0
JMC12M6N	12	3/8	43.4	22.0	14.3	33.3	22.0
JMC12M8N	12	1/2	49.0	22.0	19.1	38.9	22.0
JMC12M12N	12	3/4	50.5	22.0	19.1	40.4	27.0
JMC14M4N	14	1/4	44.2	22.0	14.3	34.1	24.0
JMC14M6N	14	3/8	44.2	22.0	14.3	34.1	24.0
JMC14M8N	14	1/2	49.0	22.0	19.1	38.9	24.0
JMC15M8N	15	1/2	49.0	22.0	19.1	38.9	24.0
JMC16M6N	16	3/8	44.1	22.0	19.1	34.1	24.0
JMC16M8N	16	1/2	49.0	22.0	19.1	38.9	24.0
JMC16M12N	16	3/4	50.5	22.0	19.1	40.5	27.0
JMC18M8N	18	1/2	50.6	22.0	19.1	40.5	27.0
JMC18M12N	18	3/4	50.6	22.0	19.1	40.5	27.0
JMC20M8N	20	1/2	50.6	22.0	19.1	42.2	30.0
JMC20M12N	20	3/4	52.3	22.0	19.1	42.2	30.0
JMC2M16N	20	1	57.7	22.0	23.8	47.6	35.0
JMC22M12N	22	3/4	52.3	22.0	19.1	42.2	35.0
JMC25M8N	25	1/2	57.5	26.5	19.1	45.3	35.0
JMC25M12N	25	3/4	57.5	26.5	19.1	45.2	35.0
JMC25M16N	25	1	62.3	26.5	23.8	50.0	35.0

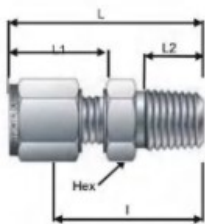

Ordering Number	Dimensions-MM						
	Tube OD	NPT Pipe Threaded	L. 1	L1	L2	I	HEX
JMC2M2R	2	1/8	29.7	15.3	9.5	23.1	12.0
JMC4M2R	4	1/8	31.2	16.1	9.7	24.6	12.0
JMC4M4R	4	1/4	36.3	16.1	14.2	29.7	14.0
JMC6M4R	6	1/4	40.0	17.7	14.2	30.5	14.0
JMC6M6R	6	3/8	38.5	17.7	14.2	31.0	18.0
JMC8M4R	8	1/4	38.7	18.6	14.2	31.2	15.0
JMC8M6R	8	3/8	39.3	18.6	14.2	31.8	18.0
JMC10M6R	10	3/8	40.9	19.5	14.2	33.3	18.0
JMC12M8R	12	1/2	49.0	22.0	19.1	38.9	22.0
JMC15M8R	15	1/2	49.0	22.0	19.1	38.9	24.0
JMC16M8R	16	1/2	49.0	22.0	19.1	38.9	24.0
JMC18M8R	18	1/2	50.6	22.0	19.1	40.4	27.0
JMC20M12R	20	3/4	52.3	22.0	19.1	42.2	30.0
JMC22M12R	22	3/4	52.3	22.0	19.1	42.2	30.0
JMC25M16R	25	1	62.3	26.5	23.9	50.0	35.0

直通终端接头
Male Connector
JMC

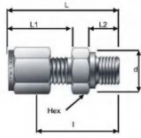

Ordering Number	Dimensions-Inch						d	HEX
	Tube OD	BSPP Threaded	L	L1	L2	I		
JMC2T2G	1/8	1/8	1.18	0.60	0.28	0.92	0.54	9/16
JMC2T4G	1/8	1/4	1.27	0.60	0.44	1.13	0.70	3/4
JMC2T6G	1/8	3/8	1.46	0.60	0.44	1.17	0.86	7/8
JMC4T2G	1/4	1/8	1.28	0.70	0.28	0.98	0.54	9/16
JMC4T4G	1/4	1/4	1.49	0.70	0.44	1.19	0.70	3/4
JMC4T6G	1/4	3/8	1.55	0.70	0.44	1.25	0.86	7/8
JMC4T8G	1/4	1/2	1.77	0.70	0.56	1.47	1.01	1-1/16
JMC6T2G	3/8	1/8	1.35	0.76	0.28	1.06	0.54	5/8
JMC6T4G	3/8	1/4	1.54	0.76	0.44	1.25	0.70	3/4
JMC6T6G	3/8	3/8	1.57	0.76	0.44	1.28	0.86	7/8
JMC6T8G	3/8	1/2	1.82	0.76	0.56	1.53	1.01	1-1/16
JMC8T4G	1/2	1/4	1.66	0.86	0.44	1.28	0.70	13/16
JMC8T6G	1/2	3/8	1.69	0.86	0.44	1.31	0.86	7/8
JMC8T8G	1/2	1/2	1.91	0.86	0.56	1.53	1.01	1-1/16
JMC12T8G	3/4	1/2	1.93	0.86	0.5	1.53	1.01	1-1/16
JMC12T12G	3/4	3/4	2.07	0.86	0.63	1.69	1.25	1-3/8
JMC16T8G	1	1/2	2.21	1.04	0.56	1.71	1.01	1-3/8
JMC16T16G	1	1	2.35	1.04	0.72	1.88	1.25	1-5/8

Ordering Number	Dimensions-Inch						d	HEX
	Tube OD	BSPP Threaded	L	L1	L2	I		
JMC2M2G	2	1/8	28.4	15.3	7.1	21.8	13.7	14.0
JMC3M3G	3	1/8	30.0	15.3	7.1	23.4	13.7	14.0
JMC3M4G	3	1/4	35.3	15.3	11.2	28.7	17.8	19.0
JMC6M2G	6	1/8	32.5	17.7	7.1	25.0	13.7	14.0
JMC6M4G	6	1/4	37.7	17.7	11.2	30.2	17.8	19.0
JMC6M6G	6	3/8	39.0	17.7	11.2	31.5	21.8	22.0
JMC6M8G	6	1/2	45.6	17.7	14.2	38.1	25.7	27.0
JMC8M2G	8	1/8	33.1	18.6	7.1	25.6	13.7	15.0
JMC8M4G	8	1/4	38.5	18.6	11.2	31.0	17.8	19.0
JMC8M6G	8	3/8	39.8	18.6	11.2	32.3	21.8	22.0
JMC8M8G	8	1/2	45.6	18.6	14.2	38.1	25.7	27.0
JMC10M4G	10	1/4	39.4	19.5	11.2	31.8	17.8	19.0
JMC10M6G	10	3/8	40.6	19.5	11.2	33.0	21.8	22.0
JMC10M8G	10	1/2	46.5	19.5	14.2	38.9	25.7	27.0
JMC12M4G	12	1/4	42.6	22.0	11.2	32.5	17.8	22.0
JMC12M6G	12	3/8	43.1	11.2	11.2	33.0	21.8	22.0
JMC12M8G	12	1/2	49.0	14.2	14.2	38.9	25.7	27.0
JMC12M12G	12	3/4	52.8	16.0	16.0	42.7	31.8	32.0
JMC16M16G	16	3/8	43.5	22.0	11.2	33.4	21.8	22.0
JMC16M8M	16	1/2	49.0	22.0	14.2	38.9	25.7	27.0
JMC18M8M	18	1/22	49.0	22.0	14.2	38.9	25.7	27.0
JMC18M12M	18	3/4	53.1	22.0	16.0	43.0	31.8	32.0
JMC20M8G	20	1/2	50.5	22.0	14.2	40.4	25.7	30.0
JMC20M12G	20	3/4	52.8	22.0	16.0	42.7	31.8	35.0
JMC22M12G	22	3/4	52.8	22.0	16.0	42.7	31.8	35.0
JMC25M12G	25	3/4	59.8	26.5	16.0	47.6	31.8	35.0
JMC25M16G	25	1	60.1	26.5	18.3	47.8	39.0	41.0

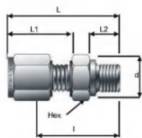

直通终端接头
Male Connector JMC

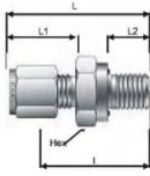

Ordering Number	Dimensions-Inch							
	Tube OD	Straight Threaded	L	L1	L2	I	HEX	O-Ring No
JMC1T2U	1/16	5/16-24	1.06	0.43	0.34	0.91	9/16	2-011
JMC2T2U	1/8	5/16-24	1.29	0.60	0.34	1.03	9/16	2-011
JMC3T3U	3/16	3/8-24	1.35	0.64	0.38	1.09	5/8	2-012
JMC4T4U	1/4	7/16-20	1.51	0.70	0.41	1.22	3/4	2-111
JMC5T5U	5/16	1/2-20	1.61	0.73	0.44	1.31	7/8	2-112
JMC6T6U	3/8	9/16-18	1.67	0.76	0.44	1.38	15/16	2-113
JMC8T8U	1/2	3/4-16	1.81	0.87	0.47	1.41	1-1/8	2-116
JMC10T10U	5/8	7/8-14	1.90	0.87	0.47	1.50	1-3/8	2-212
JMC12T12U	3/4	1-1/16-12	2.06	0.87	0.56	1.66	1-1/2	2-215
JMC16T12U	7/8	1-1/16-12	2.06	0.87	0.56	1.66	1-1/2	2-215
JMC16T16U	1	1-5/16-12	2.30	1.05	0.56	1.81	1-3/4	2-219

缩径端口接头
PCPort Connector JCP

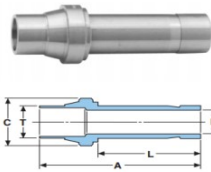

Part Number*	T Tube O. D.	Dimensions			
		A	C	E min.	L
JCP-1PC	1/16	0.73	0.13	0.03	0.55
JCP-2PC	1/8	1	0.25	0.0	0.63
JCP-4PC	1/4	1.16	0.38	0.13	0.78
JCP-6PC	3/8	1.31	0.50	0.25	0.86
JCP-8PC	1/2	2	0.69	0.33	1.30
JCP-12PC	3/4	1.83	0.94	0.53	1.13

缩径端口接头
PCPort Connector JCP1

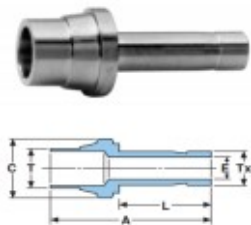

Part Number*	T Tube O. D.	TX Reduced Tube O. D.	Dimensions			
			A	C	E min.	L
JCP-2PC1	1/8	1/16	0.84	0.25	0.03	0.47
JCP-4PC1	1/4	1/16	0.95	0.38	0.03	0.56
JCP-4PC2	1/4	1/8	1.06	0.38	0.06	0.66
JCP-6PC2	3/8	1/8	1.16	0.50	0.09	0.70
JCP-6PC4	3/8	1/4	1.22	0.50	0.13	0.78
JCP-8PC4	1/2	1/4	1.47	0.69	0.13	0.77
JCP-8PC6	1/2	3/8	1.55	0.69	0.25	0.83
JCP-12PC8	3/4	1/2	2	0.94	0.33	1.14

45 度弯头终端
45 Male Elbow JL45

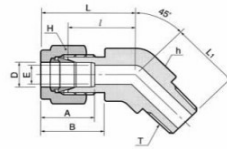

Part No.	Yube O. D. D		T NPT	E Min	Width across flat				A	B	I	L	L1
	in	mm			h		H						
					in	mm	in	mm					
JL45-2T-2NM	1/8	3.17	1/8	2.4	1/2	12.70	7/16	11.11	12.70	15.24	15.77	22.38	16.51
JL45-4T-2NM	1/4	6.35	1/8	4.82	1/2	12.70	9/16	14.28	15.24	17.78	17.27	24.63	16.51
JL45-4T-4NM	1/4	6.35	1/4	4.82	1/2	12.70	9/16	14.28	15.24	17.78	17.27	24.63	21.08
JL45-6T-2NM	3/8	9.52	1/8	4.82	5/8	15.87	11/16	17.46	16.76	19.30	20.57	27.94	18.28
JL45-6T-4NM	3/8	9.52	1/4	7.11	5/8	15.87	11/16	17.46	16.76	19.30	20.57	27.94	22.86
JL45-6T-6NM	3/8	9.52	3/8	7.11	13/16	20.64	11/16	17.46	16.76	19.30	21.84	29.21	24.13
JL45-8T-6NM	1/2	12.70	3/8	9.65	13/16	20.64	7/8	22.22	22.86	21.84	21.84	32.00	24.13
JL45-8T-8NM	1/2	12.70	1/2	1.41	13/16	20.64	7/8	22.22	22.86	21.84	21.84	32.00	28.95
JL45-12T-12NM	3/4	19.05	3/4	15.74	1-1/8	28.58	1-1/8	28.58	24.38	21.84	23.87	34.03	30.98
JL45-16T-16NM	1	25.40	1	22.35	1-3/8	34.93	1-1/2	38.10	31.24	26.41	28.19	40.38	37.84

45 度弯头公制终端
45 Male Elbow JL45M

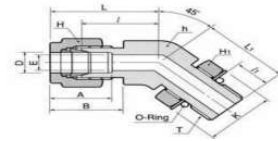

Part No.	Yube O. D	T NPT	E Min	Width across flat		A	B	I	L	L1
	D			h	H					
JL45M-6MM-4NM	6	1/4	4.8	12.7	14.0	15.3	17.7	21.8	29.4	22.9
JL45M-12MM-8NM	12	1/2	9.5	20.64	22.0	22.8	22.0	21.8	31.9	29.0

45 度弯头可调
45SAE Male Elbow JL45-0G

Part No.	Yube O. D. D		Straight Thread T (U)	E Min	Width across flat						A	B	I	I1	L	L1	K	O-Ring Uniform Size Number
	in	mm			h		H		H1									
					in	mm	in	mm	in	mm								
JL45 4T4-0G	1/4	6.35	7/16-20	4.82	1/2	12.70	9/16	14.28	9/16	14.28	15.24	17.78	18.28	9.9	25.65	25.65	16.51	-904
JL45 6T6-0G	3/8	9.52	9/16-18	7.11	5/8	15.87	11/16	17.46	11/16	17.46	16.76	19.30	20.57	11.17	27.94	28.19	20.06	-906
JL45 8T8-0G	1/2	12.70	3/4-16	10.41	13/16	20.64	7/8	22.22	7/8	22.22	22.86	21.84	21.84	12.70	32.00	32.25	25.65	-908
JL45 12T12-0G	3/4	19.05	1-1/16-12	15.74	1-1/8	28.58	1-1/8	28.58	1-1/4	31.75	24.38	21.84	29.71	16.76	39.87	47.24	36.57	-912
JL45 16T16-0G	1	25.40	1-5/16-12	22.35	1-3/8	34.92	1-1/2	38.10	1-1/2	38.10	31.24	26.41	35.30	16.76	47.49	50.54	43.94	-916

直通穿版终端
Bulkhead Male Connector
JMCB-N

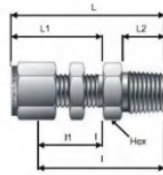

Ordering Number	Dimensions-Inch									
	Tube OD	NPT Threaded	L	L1	L2	I	I1	HEX	Panel Hole Size	Max Pand Th" x
JMCB-1T2N	1/16	1/8	1.27	0.68	0.38	1.12	0.53	7/16	13/64	1/8
JMCB-2T2N	1/8	1/8	1.83	1.23	0.38	1.57	0.97	1/2	21/64	1/2
JMCB-3T2N	3/16	1/8	1.89	1.26	0.38	1.63	1.00	9/16	25/64	1/2
JMCB-4T2N	1/4	1/8	1.95	1.31	0.38	1.66	1.02	5/8	29/64	17/32
JMCB-4T4N	1/4	1/4	2.13	1.31	0.56	1.08	1.02	5/8	29/64	17/32
JMCB-4T6N	1/4	3/8	2.16	1.31	0.56	1.87	1.02	11/16	29/64	17/32
JMCB-4T8N	1/4	1/2	2.37	1.31	0.75	2.08	1.02	7/8	29/64	17/32
JMCB-5T2N	5/16	1/8	2.08	1.42	0.38	1.78	1.12	11/16	33/64	9/16
JMCB-5T4N	5/16	1/4	2.27	1.42	0.56	1.97	1.12	11/16	33/64	9/16
JMCB-6T2N	3/8	1/8	2.08	1.44	0.38	1.79	1.15	3/4	37/64	9/16
JMCB-6T4N	3/8	1/4	2.26	1.44	0.56	1.98	1.15	3/4	37/64	9/16
JMCB-6T6N	3/8	3/8	2.26	1.44	0.56	1.98	1.15	3/4	37/64	9/16
JMCB-6T8N	3/8	1/2	2.48	1.44	0.75	2.22	1.15	7/8	37/64	9/16
JMCB-8T4N	3/8	1/4	2.49	1.65	0.56	2.09	1.25	15/16	49/64	19/32
JMCB-8T6N	1/2	3/8	2.49	1.65	0.56	2.09	1.25	15/16	49/64	19/32
JMCB-8T8N	1/2	1/2	2.71	1.65	0.75	2.31	1.25	15/16	49/64	19/32
JMCB-8T12N	1/2	3/4	2.72	1.65	0.75	2.32	1.25	1-1/8	49/64	19/32
JMCB-10T6N	5/8	3/8	2.63	1.68	0.56	2.23	1.28	1-1/16	57/64	19/32
JMCB-10T8N	5/8	1/2	2.82	1.68	0.75	2.42	1.28	1-1/16	57/64	19/32
JMCB-12T8N	3/4	1/2	2.00	1.87	0.75	2.60	1.47	1-3/16	1-1/64	25/32
JMCB-12T12N	3/4	3/4	3.00	1.87	0.75	2.60	1.47	1-3/16	1-1/64	25/32
JMCB-14T12N	7/8	3/4	3.31	2.09	0.75	2.91	1.69	1-3/8	1-9/64	15/16
JMCB-16T12N	1	3/4	3.54	2.27	0.75	3.00	1.78	1-5/8	1-21/64	15/16
JMCB-16T16N	1	1	3.72	2.27	0.94	3.19	1.75	1-5/8	1-21/64	15/16

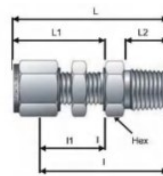

Ordering Number	Dimensions-MM									
	Tube OD	NPT Threaded	L	L1	L2	I	I1	HEX	Panel Hole Size	Max Pand Th" x
JMCB-6M2N	6	1/8	49.6	33.7	9.5	42.1	26.2	16.0	11.5	10.2
JMCB-6M4N	6	1/4	53.5	33.7	14.3	46.0	26.2	16.0	11.5	10.2
JMCB-8M2N	8	1/8	52.3	36.0	9.5	44.8	28.5	18.0	13.1	11.2
JMCB-8M4N	8	1/4	57.5	36.0	14.3	50.0	28.5	18.0	13.1	11.2
JMCB-10M4N	10	1/4	58.4	37.0	14.3	50.8	29.4	22.0	16.3	11.2
JMCB-10M6N	10	3/8	58.4	37.0	14.3	50.8	29.4	22.0	16.3	11.2
JMCB-10M8N	10	1/2	63.1	37.0	19.1	55.5	29.4	22.0	16.3	11.2
JMCB-12M4N	12	1/4	53.3	40.1	14.3	53.2	31.8	24.0	19.5	12.7
JMCB-12M6N	12	3/8	64.5	40.1	14.3	54.4	31.8	24.0	19.5	12.7
JMCB-12M8N	12	1/2	67.5	40.1	19.1	57.4	31.8	24.0	19.5	12.7

直通卡套管接头
Reducer JR

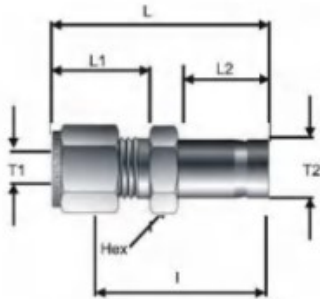

Ordering Number	Dimensions-Inch						
	T1	T2	L	L1	L2	I	HEX
JR2T1T-R	1/8	1/16	1.18	0.60	0.38	0.92	7/16
JR2T2T-R	1/8	1/8	1.34	0.43	0.54	1.09	7/16
JR2T3R-R	1/8	3/16	1.35	0.60	0.58	1.09	7/16
JR2T4T-R	1/8	1/4	1.42	0.60	0.63	1.16	7/16
JR2T6T-R	1/8	3/8	1.48	0.60	0.69	1.22	7/16
JR3T2T-R	3/16	1/8	1.37	0.63	0.53	1.11	7/16
JR3T4T-R	3/16	1/4	1.46	0.63	0.63	1.20	7/16
JR4T2T-R	1/4	1/8	1.45	0.70	0.53	1.16	1/2
JR4T3T-R	1/4	3/16	1.48	0.70	0.56	1.19	1/2
JR4T4T-R	1/4	1/4	1.54	0.70	0.63	1.25	1/2
JR4T5T-R	1/4	5/16	1.57	0.70	0.66	1.28	1/2
JR4T6T-R	1/4	3/8	1.60	0.70	0.69	1.31	1/2
JR4T8T-R	1/4	1/2	1.82	0.70	0.91	1.53	9/16
JR5T6T-R	5/16	3/8	1.65	0.73	0.69	1.36	9/16
JR5T8T-R	5/16	1/2	1.87	0.73	0.91	1.58	9/16
JR6T4T-R	3/8	1/4	1.63	0.76	0.63	1.34	5/8
JR6T6T-R	3/8	3/8	1.70	0.76	0.69	1.41	5/8
JR6T8T-R	3/8	1/2	1.91	0.76	0.91	1.62	5/8
JR8T4T-R	1/2	1/4	1.77	0.87	0.63	1.37	13/16
JR8T6T-R	1/2	3/8	1.84	0.87	0.69	1.44	13/16
JR8T10T-R	1/2	5/8	2.12	0.87	0.97	1.72	13/16
JR8T12T-R	1/2	3/4	2.12	0.87	0.97	1.72	13/16
JR10T12T-R	5/8	3/4	2.15	0.87	0.97	1.75	15/16
JR10T14T-R	5/8	7/8	2.21	0.87	1.03	1.81	15/16
JR12T8T-R	3/4	1/2	2.15	0.87	0.91	1.75	1-1/16
JR12T16T-R	3/4	1	2.46	0.87	1.22	2.06	1-1/16
JR16T24T-R	1	1-1/2	3.52	1.05	2.05	3.03	1-5/8
JR20T24T-R	1-1/4	1-1/2	4.10	1.52	2.05	3.23	1-7/8
JR24T32T-R	1-1/2	2	5.17	1.52	2.74	4.10	2-1/4

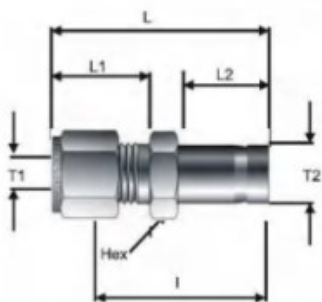

Ordering Number	Dimensions-MM						
	T1	T2	L	L1	L2	I	HEX
JR3M3M	3	4	35.0	15.3	14.3	28.4	12.0
JR4M6M	4	6	37.1	16.1	15.9	30.5	12.0
JR6M8M	6	8	40.0	17.7	16.7	32.5	14.0
JR6M10M	6	10	40.8	17.7	17.5	33.3	14.0
JR6M12M	6	12	46.4	17.7	23.0	38.9	14.0
JR8M6M	8	6	40.0	18.6	15.9	32.5	15.0
JR8M10M	8	10	42.0	18.6	17.5	34.5	15.0
JR8M12M	8	12	47.6	18.6	23.0	40.1	15.0
JR10M6M	10	6	40.8	17.7	17.5	33.3	14.0
JR10M8M	10	8	42.0	18.6	17.5	34.5	15.0
JR10M12M	10	12	49.7	19.5	23.0	42.1	18.0
JR12M6M	12	6	44.9	22.0	15.9	34.8	22.0
JR12M10M	12	10	46.6	22.0	17.5	36.5	22.0
JR12M16M	12	16	53.8	22.0	24.6	43.7	22.0
JR16M12M	16	12	56.0	22.0	23.0	42.9	24.0
JR16M18M	16	18	54.7	22.0	24.8	44.6	22.0
JR16M20M	16	20	55.3	22.0	25.6	45.2	22.0
JR18M12M	18	12	54.6	22.0	23.0	44.5	27.0
JR18M16M	18	16	56.1	22.0	24.6	46.0	27.0
JR18M20M	18	20	57.6	22.0	25.4	47.5	27.0
JR18M22M	18	22	56.1	22.0	26.2	46.0	27.0
JR20M18M	20	18	57.9	22.0	24.6	47.8	30.0
JR20M22M	20	22	57.7	22.0	26.2	47.6	30.0
JR20M25M	20	25	64.2	22.0	31.8	54.1	30.0
JR25M16M	25	16	63.2	26.5	24.8	51.0	35.0
JR25M18M	25	18	63.1	26.5	24.6	50.8	35.0
JR25M20M	25	20	64.5	26.5	25.4	52.3	35.0

直通卡套管接头
Reducer JR

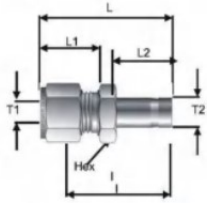

Ordering Number	Dimensions-MM						
	T1	T2	L	L1	L2	I	HEX
JR6M4T-R	6	1/4	39.3	17.7	16.0	31.8	14.0
JR6M5T-R	6	5/16	40.0	17.7	16.8	32.5	14.0
JR6M6T-R	6	3/8	40.8	17.7	17.5	33.3	14.0
JR6M8T-R	6	1/2	46.4	17.7	23.1	38.9	14.0
JR8M6T-R	8	3/8	42.0	18.6	17.5	34.5	15.0
JR8M8T-R	8	1/2	47.5	18.6	23.1	40.1	15.0
JR10M6T-R	10	3/8	44.4	19.5	17.5	36.8	18.0
JR10M8T-R	10	1/2	47.6	19.5	23.1	41.4	18.0
JR12M8T-R	10	1/2	52.3	22.0	23.1	42.2	22.0
JR12M12T-R	12	3/4	53.8	22.0	24.6	43.7	22.0
JR18M12T-R	18	3/4	57.5	22.0	24.6	47.5	27.0

直通穿板卡套管接头
Bulkhead Adapter JRB

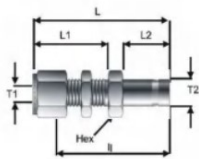

Ordering Number	Dimensions-Inch						
	T1	T2	L	L1	L2	I	HEX
JRB2T2T-BR	1/8	1.95	1.23	0.53	1.69	0.97	1/2
JRB4T4T-BR	1/4	2.20	1.31	0.63	1.91	1.02	5/8
JRB6T6T-BR	3/8	2.42	1.44	0.69	2.13	1.15	3/4
JRB8T8T-BR	1/2	2.87	1.65	0.91	2.47	1.25	15/16

直通内丝卡套接头
Female Connector JCF

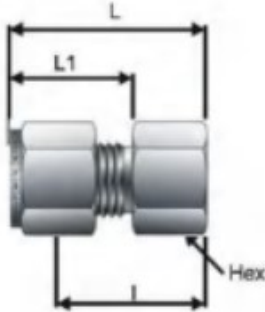

Ordering Number	Dimensions-MM					
	Tube OD	NPT Threaded	L1	L1	I	HEX
JCF2T2N	1/8	1/8	1.14	0.60	0.88	9/16
JCF2T4N	1/8	1/4	1.22	0.60	1.06	3/4
JCF3T2N	3/16	1/8	1.17	0.64	0.91	9/16
JCF3T4N	3/16	1/4	1.35	0.64	1.09	3/4
JCF4T2N	1/4	1/8	1.23	0.70	0.94	9/16
JCF4T4N	1/4	1/4	1.42	0.70	1.13	3/4
JCF4T6N	1/4	3/8	1.48	0.70	1.19	7/8
JCF4T8N	1/4	1/2	1.67	0.70	1.38	1-1/16
JCF6T2N	3/8	1/8	1.29	0.76	1.00	5/8
JCF6T4N	3/8	1/4	1.48	0.76	1.19	3/4
JCF6T6N	3/8	3/6	1.54	0.76	1.25	7/8
JCF6T8N	3/8	1/2	1.73	0.76	1.44	1-1/16
JCF8T4N	1/2	1/4	1.59	0.87	1.19	13/16
JCF8T6N	1/2	3/8	1.65	0.87	1.25	7/8
JCF8T8N	1/2	1/2	1.84	0.87	1.44	1-1/16
JCF8T12N	1/2	3/4	1.96	0.87	1.56	1-1/4

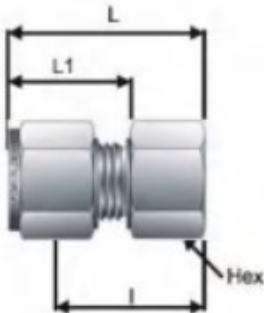

Ordering Number	Dimensions-MM					
	Tube OD	NPT Threaded	L1	L1	I	HEX
JCF4M2N	4	1/8	29.6	16.1	23.0	14.0
JCF6M2N	6	1/8	31.3	17.7	23.8	14.0
JCF6M4N	6	1/4	36.1	17.7	28.6	19.0
JCF6M6N	6	3/8	37.7	17.7	30.2	22.0
JCF6M8N	6	1/2	42.5	17.7	35.0	27.0
JCF8M2N	8	1/8	32.1	18.6	24.6	14.0
JCF8M4N	8	1/4	36.9	18.6	29.4	19.0
JCF8M6N	8	3/8	38.5	18.6	31.0	22.0
JCF10M4N	10	1/4	37.8	19.5	30.2	19.0
JCF10M6N	10	3/8	39.4	19.5	31.8	22.0
JCF10M8N	10	1/2	44.1	19.5	36.5	27.0
JCF12M4N	12	1/4	41.9	22.0	31.8	22.0
JCF12M6N	12	3/8	41.9	22.0	31.8	22.0
JCF12M8N	12	1/2	46.6	22.0	36.5	27.0

直通内丝卡套接头
Female Connector JCF-R

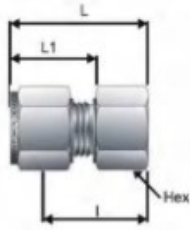
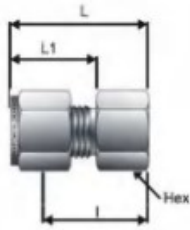

Ordering Number	Dimensions-Inch					
	Tube OD	BSPT Pipe Threaded	L	L1	I	HEX
JCF4T2R	1/4	1/8	1.24	0.70	0.94	9/16
JCF4T4R	1/4	1/4	1.42	0.70	1.13	3/4
JCF4T6R	1/4	3/8	1.49	0.70	1.19	7/8
JCF4T8R	1/4	1/2	1.68	0.70	1.38	1-1/16
JCF6T4R	3/8	1/4	1.48	0.76	1.19	3/4
JCF6T6R	3/8	3/8	1.54	0.76	1.25	7/8
JCF6T8R	3/8	1/2	1.73	0.76	1.44	1-1/16
JCF8T4R	1/2	1/2	1.59	0.87	1.19	13/16
JCF8T6R	1/2	3/8	1.65	0.87	1.25	7/8
JCF8T8R	1/2	1/2	1.84	0.87	1.44	1-1/16

Ordering Number	Dimensions-MM					
	Tube OD	BSPT Pipe Threaded	L	L1	I	HEX
JCF6M2R	6	1/8	31.3	17.7	23.8	14.0
JCF6M4R	6	1/4	35.8	17.7	28.3	19.0
JCF6M6R	6	3/8	37.6	17.7	30.1	22.0
JCF8M2R	8	1/8	32.8	18.6	25.3	15.0
JCF8M4R	8	1/4	37.0	18.6	2.5	19.0
JCF8M6R	8	3/8	38.5	18.6	31.0	22.0
JCF10M4R	10	1/4	37.8	19.5	30.2	19.0
JCF10M6R	10	3/8	39.4	19.5	31.8	22.0
JCF10M8R	10	1/2	44.2	19.5	36.6	27.0
JCF12M4R	12	1/4	40.3	22.0	30.2	22.0
JCF12M6R	12	3/8	41.9	22.0	31.8	22.0
JCF12M8R	12	1/2	46.7	22.0	36.6	27.0

直通穿板内丝卡套接头
Bulkhead Female Connector JCFB

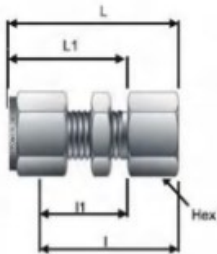

Ordering Number	Dimensions-Inch						
	Tube OD	NPT Pipe Threaded	L	L1	I	I1	HEX
JCFB4T2N	1/4	1/8	1.85	1.31	1.56	1.02	5/8
JCFB4T4N	1/4	1/4	2.04	1.31	1.75	1.02	3/4
JCFB6T4N	3/8	1/4	2.17	1.44	1.88	1.15	3/4
JCFB8T6N	1/2	3/8	2.43	1.65	2.03	1.25	15/16
JCFB8T8N	1/2	1/2	2.62	1.65	2.22	1.25	1-1/16

Ordering Number	Dimensions-MM						
	Tube OD	NPT Pipe Threaded	L	L1	I	I1	HEX
JCFB6M2N	6	1/8	47.2	33.7	39.7	26.2	16.0
JCFB6M4N	6	1/4	52.0	33.7	44.5	26.2	19.0
JCFB8M2N	8	1/8	49.6	36.1	42.1	28.5	18.0
JCFB10M4N	10	1/4	55.2	37.0	47.6	29.4	19.0
JCFB12M6N	12	3/8	60.9	41.9	50.8	31.8	24.0
JCFB12M8N	12	1/2	66.4	41.9	56.3	31.8	27.0

直通内螺纹卡套接头
Female Connector JCF

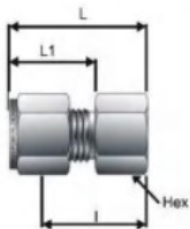

Ordering Number	Dimensions-Inch					
	Tube OD	NPT Pipe Threaded	L	L1	I	HEX
JCF4T4G	1/4	1/4	1.48	0.70	1.19	3/4
JCF6T6G	3/8	3/8	1.55	0.76	1.25	7/8
JCF6T8G	3/8	1/2	1.63	0.76	1.33	1-1/16
JCF8T6G	1/2	3/8	1.75	0.86	1.35	7/8
JCF8T8G	1/2	1/2	1.90	0.86	1.50	1-1/16

Ordering Number	Dimensions-MM					
	Tube OD	NPT Pipe Threaded	L	L1	I	HEX
JCF6M4G	6	1/4	37.7	17.7	30.2	19.0
JCF8M4G	8	1/4	38.5	18.8	31.0	19.0
JCF10M6G	10	3/8	38.8	19.5	31.2	22.0
JCF12M4G	12	1/4	41.9	22.0	31.8	22.0
JCF12M6G	12	3/8	44.4	22.0	34.3	22.0
JCF12M8G	12	1/2	48.2	22.0	38.1	27.0

直通外丝卡套管接头
Male Adapter JAM

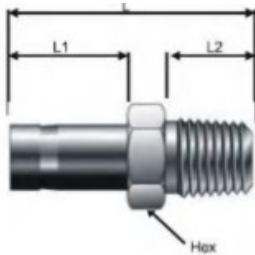

Ordering Number	Dimensions-Inch					
	Tube OD	NPT Pipe Threaded	L	L1	L2	HEX
JAM1T2N	1/16	1/8	1.00	0.38	0.38	7/16
JAM2T2N	1/8	1/8	1.16	0.54	0.38	7/16
JAM2T4N	1/8	1/4	1.38	0.54	0.56	9/16
JAM3T2N	3/16	1/8	1.20	0.58	0.38	7/16
JAM3T4N	3/16	1/4	1.42	0.58	0.56	9/16
JAM4T2N	1/4	1/8	1.25	0.63	0.38	7/16
JAM4T4N	1/4	1/4	1.46	0.63	0.56	9/16
JAM4T6N	1/4	3/8	1.49	0.63	0.56	11/16
JAM4T8N	1/4	1/2	1.71	0.63	0.75	7/8
JAM5T2N	5/16	1/8	1.29	0.66	0.38	7/16
JAM5T4N	5/16	1/4	1.50	0.66	0.56	9/16
JAM5T6N	5/16	3/8	1.53	0.66	0.56	11/16
JAM5T8N	5/16	1/2	1.74	0.66	0.75	7/8
JAM6T2N	3/8	1/8	1.32	0.69	0.38	7/16
JAM6T4N	3/8	1/4	1.53	0.69	0.56	9/16
JAM6T6N	3/8	3/8	1.56	0.69	0.56	11/16
JAM6T8N	3/8	1/2	1.78	0.69	0.75	7/8
JAM8T4N	1/2	1/4	1.75	0.91	0.56	9/16
JAM8T6N	1/2	3/8	1.78	0.91	0.56	11/16
JAM8T8N	1/2	1/2	2.00	0.91	0.75	7/8
JAM10T8N	5/8	1/2	2.06	0.97	0.75	7/8
JAM12T8N	3/4	1/2	2.06	0.97	0.75	7/8
JAM12T12N	3/4	3/4	2.06	0.97	0.75	1-1/16
JAM12T16N	3/4	1	2.41	0.97	0.94	1-3/8
JAM16T12N	1	3/4	2.31	1.22	0.75	1-1/16
JAM16T16N	1	1	2.68	1.22	0.94	1-3/8
JAM20T20N	1-1/4	1-1/4	3.16	1.71	0.97	1-3/4
JAM24T24N	1-1/2	1-1/2	3.72	2.05	1.00	2-1/8
JAM32T32N	2	2	4.70	2.74	1.04	2-3/4

直通外丝卡套管接头
Male Adapter JAM-R

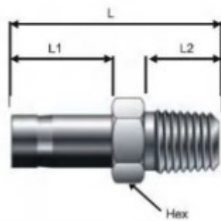

Ordering Number	Dimensions-MM					
	Tube OD	BSPT Pipe Threaded	L	L1	L2	HEX
JAM6M2R	6	1/8	31.3	17.7	23.8	14.0
JAM6M4R	6	1/4	35.8	17.7	28.3	19.0
JAM8M4R	6	3/8	37.6	17.7	30.1	22.0
JAM8M6R	8	1/8	32.8	18.6	25.3	15.0
JAM10M4R	8	1/4	37.0	18.6	29.5	19.0
JAM10M6R	8	3/8	38.5	18.6	31.0	22.0
JAM10M8R	10	1/4	37.8	19.5	30.2	19.0
JAM12M4R	10	3/8	39.4	19.5	31.8	22.0
JAM12M6R	10	1/2	44.2	19.5	36.6	27.0
JAM12M8R	12	1/4	40.3	22.0	30.2	22.0
JAM16M8R	12	3/8	41.9	22.0	31.8	22.0

直通内丝卡套管接头
Female Adapter JAF

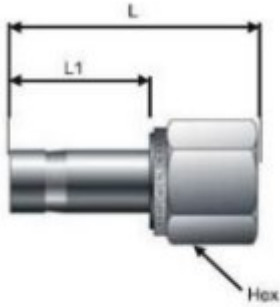

Ordering Number	Dimensions-Inch				
	Tube OD	NPT Threaded	L	L1	HEX
JAF2T2N	1/8	1/8	1.23	0.53	9/16
JAF2T4N	1/8	1/4	1.38	0.53	3/4
JAF3T2N	3/16	1/8	1.25	0.56	9/16
JAF3T4N	3/16	1/4	1.42	0.56	3/4
JAF4T2N	1/4	1/8	1.31	0.63	9/16
JAF4T4N	1/4	1/4	1.47	0.63	3/4
JAF4T6N	1/4	3/8	1.56	0.63	7/8

Ordering Number	Dimensions-MM				
	Tube OD	NPT Threaded	L	L1	HEX
JAF4M2N	4	1/8	28.6	14.3	14.0
JAF6M2N	6	1/8	30.2	15.9	14.0
JAF8M4N	8	1/4	39.1	16.7	19.0
JAF10M4N	10	1/4	36.5	17.5	19.0
JAF10M6N	10	3/8	31.8	17.5	22.0
JAF10M8N	10	1/2	41.3	17.5	27.0
JAF12M4N	12	1/4	40.5	23.0	19.0
JAF12M6N	12	3/8	43.7	23.0	22.0
JAF12M8N	12	1/2	46.8	23.0	27.0
JAF16M8N	16	1/2	48.4	24.6	27.0
JAF18M12N	18	3/4	51.6	24.6	32.0
JAF20M12N	20	3/4	52.4	25.4	32.0
JAF25M16N	25	1	66.7	31.8	41.0

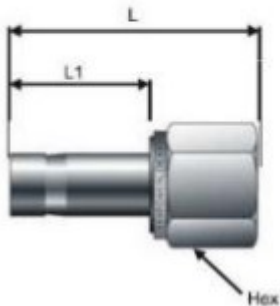

Ordering Number	Dimensions-Inch				
	Tube OD	NPT Threaded	L	L1	HEX
JAF2T6N	1/4	1/4	1.47	0.63	3/4
JAF6T6N	3/8	3/8	1.53	0.69	7/8
JAF8T8N	1/2	1/2	1.91	0.91	1-1/16

Ordering Number	Dimensions-MM				
	Tube OD	BSPT Pipe Threaded	L	L1	HEX
JAF4M2R	4	1/8	29.4	14.3	14.0
JAF6M2R	6	1/8	31.0	15.9	14.0
JAF6M4R	4	1/4	37.3	15.9	19.0
JAF8M4R	8	1/4	38.1	16.7	19.0
JAF10M4R	10	1/4	38.9	17.5	19.0
JAF10M8R	10	1/2	43.7	17.5	27.0
JAF12M6R	12	3/8	44.5	23.0	22.0
JAF12M8R	12	1/2	48.4	23.0	27.0
JAF16M8R	16	1/2	50.0	24.6	27.0
JAF18M12R	18	3/4	53.2	24.6	32.0
JAF20M12R	20	3/4	54.0	25.4	32.0
JAF25M16R	25	1	67.5	31.8	41.0

直角中间接头 Union Elbow JL

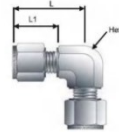
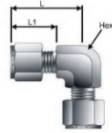

Ordering Number	Dimensions-Inch			
	Tube OD	L	I	HEX
JL1T	1/16	0.70	0.55	3/8
JL2T	1/8	0.88	0.62	3/8
JL3T	3/16	1.00	0.74	1/2
JL4T	1/4	1.06	0.77	1/2
JL5T	5/16	1.13	0.84	9/16
JL6T	3/8	1.20	0.91	5/8
JL8T	1/2	1.42	1.02	13/16
JL10T	5/8	1.50	1.10	15/16
JL12T	3/4	1.57	1.17	1-1/16
JL14T	7/8	1.76	1.36	1-3/8
JL16T	1	1.93	1.45	1-3/8
JL20T	1-1/4	2.61	1.75	1-5/8
JL24T	1-1/2	3.06	2.00	1-7/8
JL32T	2	4.22	2.75	2-13/16

Ordering Number	Dimensions-MM			
	Tube OD	L	I	HEX
JL3M-UE	3	22.3	15.7	3/8
JL4M-UE	4	25.4	18.8	1/2
JL6M-UE	6	27.0	19.6	1/2
JL8M-UE	8	28.8	21.3	9/16
JL10M-UE	10	31.5	23.9	11/16
JL12M-UE	12	36.0	25.9	13/16
JL14M-UE	14	38.1	28.0	15/16
JL15M-UE	15	38.0	27.9	15/16
JL16M-UE	16	38.0	27.9	15/16
JL18M-UE	18	39.8	29.7	1-1/16
JL20M-UE	20	44.6	34.5	1-3/8
JL22M-UE	22	44.6	34.5	1-3/8
JL25M-UE	25	49.1	36.8	1-3/8

直角变径中间接头 Reducing Union Elbow JRL

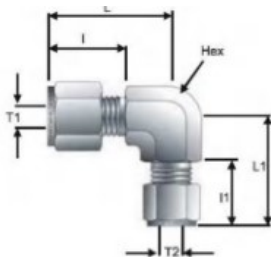

Ordering Number	Dimensions-Inch						
	Tube OD	Tube OD2	L	L1	I	I1	HEX
JRL3T2T	3/16	1/8	1.01	0.96	0.74	0.70	1/2
JRL4T2T	1/4	1/8	1.06	0.96	0.77	0.70	1/2
JRL5T2T	5/16	1/8	1.17	1.04	0.88	0.78	5/8
JRL5T4T	5/16	1/4	1.17	1.14	0.88	0.85	5/8
JRL6T2T	3/8	1/8	1.20	1.04	0.91	0.78	5/8
JRL6T4T	3/8	1/4	1.20	1.17	0.91	0.85	5/8
JRL6T5T	3/8	5/16	1.20	1.17	0.91	0.88	5/8
JRL8T4T	1/2	1/4	1.42	1.25	1.02	0.96	13/16
JRL8T5T	1/2	5/16	1.42	1.28	1.02	0.99	13/16
JRL8T6T	1/2	3/8	1.42	1.31	1.02	1.02	13/16
JRL10T6T	5/8	3/8	1.50	1.39	1.10	1.10	15/16
JRL10T8T	5/8	1/2	1.50	1.50	1.10	1.10	15/16
JRL12T4T	3/4	1/4	1.56	1.39	1.16	1.10	1-1/16
JRL12T6T	3/4	3/8	1.56	1.45	1.16	1.16	1-1/16
JRL12T8T	3/4	1/2	1.56	1.56	1.16	1.16	1-1/16
JRL16T8	1	1/2	1.94	1.76	1.45	1.36	1-3/8
JRL16T12T	1	3/4	1.94	1.76	1.45	1.36	1-3/8

直角终端接头
Male Elbow JLMC

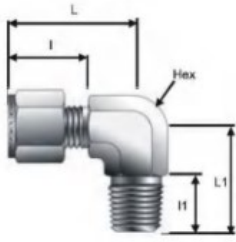

Ordering Number	Dimensions-Inch							
	Tube OD	NPT Threaded	Pipe	L	L1	I	I1	HEX
JLMC1T1N	1/16	1/16		0.75	0.70	0.60	0.38	7/16
JLMC1T2N	1/16	1/8		0.75	0.70	0.0.	0.38	7/16
JLMC2T1N	1/8	1/16		0.93	0.70	0.67	0.38	7/16
JLMC2T2N	1/8	1/8		0.93	0.70	0.67	0.38	7/16
JLMC2T4N	1/8	1/4		0.97	0.93	0.72	0.56	9/16
JLMC3T2N	3/16	1/8		1.00	0.74	0.74	0.38	1/2
JLMC3T4N	3/16	1/4		1.00	0.93	0.74	0.56	9/16
JLMC4T1N	1/4	1/16		1.06	0.74	0.77	0.38	1/2
JLMC4T2N	1/4	1/8		1.06	0.74	0.77	0.38	1/2
JLMC4T4N	1/4	1/4		1.06	0.9.	0.77	0.56	9/16
JLMC4T6N	1/4	3/8		1.17	1.04	0.88	0.56	11/16
JLMC4T8N	1/4	1/2		1.25	1.31	0.96	0.75	13/18
JLMC5T2N	5/16	1/8		1.13	0.79	0.84	0.38	9/16
JLMC5T4N	5/16	1/4		1.13	0.97	0.84	0.56	9/16
JLMC6T2N	3/8	1/8		1.20	0.82	0.91	0.38	5/8
JLMC6T4N	3/8	1/4		1.20	1.01	0.91	0.56	5/8
JLMC6T6N	3/8	3/8		1.23	1.13	0.97	0.56	11/16
JLMC6T8N	3/8	1/2		1.31	1.31	1.02	0.75	13/16
JLMC6T12N	3/8	3/4		1.46	1.46	1.17	0.75	1-1/16
JLMC8T4N	1/2	1/4		1.42	1.12	1.02	0.56	13/16
JLMC8T6N	1/2	3/8		1.42	1.12	1.02	0.56	13/16
JLMC8T8N	1/2	1/2		1.42	1.31	1.02	0.75	13/16
JLMC8T12N	1/2	3/4		1.57	1.46	1.17	0.75	1-1/16
JLMC10T6N	5/8	3/8		1.50	1.20	1.10	0.56	15/16
JLMC10T8N	5/8	1/2		1.52	1.39	1.10	0.75	15/16
JLMC10T12N	5/8	3/4		1.57	1.46	1.17	0.75	1-1/16
JLMC12T8N	3/4	1/2		1.57	1.46	1.17	0.75	1-1/16
JLMC12T12N	3/4	3/4		1.57	1.46	1.17	0.75	1-1/16
JLMC14T12N	7/8	1/2		1.76	1.65	1.36	0.75	1-3/8
JLMC16T12N	1	3/4		1.93	1.65	1.45	0.75	1-3/8
JLMC16T16N	1	1		1.93	1.84	1.45	0.94	1-3/8
JLMC20T20N	1-1/4	1-1/4		2.61	1.88	1.75	0.97	1-5/8
JLMC24T24N	1-1/2	1-1/2		3.06	2.38	2.00	1.00	1-7/8
JLMC32T32N	2	2		4.22	2.79	2.75	1.04	2-13/16

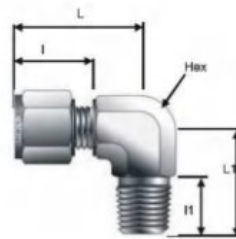

Ordering Number	Dimensions-MM							
	Tube OD	NPT Threaded	Pipe	L	L1	I	I1	HEX
JLMC6M2N	6	1/8		27.0	18.8	19.6	9.7	1/2
JLMC6M4N	6	1/4		27.0	23.4	19.6	14.2	1/2
JLMC6M6N	8	3/8		29.8	36.2	22.4	14.2	11/16
JLMC6M8N	6	1/2		31.8	33.0	24.4	19.0	13/16
JLMC8M2N	8	1/8		28.8	19.8	21.3	9.7	9/16
JLMC8M4N	8	1/4		28.8	24.4	21.3	14.2	9/16
JLMC8M6N	8	3/8		30.6	26.2	23.1	14.2	11/16
JLMC8M8N	10	1/2		32.7	33.0	25.2	19.0	13/16
JLMC10M2N	10	3/4		31.5	21.6	23.9	9.7	11/16
JLMC10M4N	10	1/4		31.5	26.2	23.9	14.2	11/16
JLMC10M6N	10	3/8		31.5	26.2	23.9	14.2	11/16
JLMC10M8N	10	1/2		33.5	33.0	25.9	19.0	13/16
JLMC12M4N	12	1/4		36.0	28.2	25.9	14.2	13/16
JLMC12M6N	12	3/8		36.0	28.2	25.9	14.2	13/16
JLMC12M8N	12	1/2		36.0	33.0	25.9	19.0	13/16
JLMC12M12N	12	3/4		39.8	36.8	29.7	19.0	1-1/16
JLMC15M8N	15	1/2		38.0	35.1	27.9	19.0	15/16
JLMC16M16N	16	3/8		38.0	30.2	27.9	14.2	15/16
JLMC16M8N	16	1/4		38.0	35.1	27.9	19.0	1/16
JLMC18M12N	16	3/8		39.8	36.8	29.7	19.0	1-1/16
JLMC18M8N	18	1/2		39.8	36.8	29.7	19.0	1-1/16

直角终端接头 Male Elbow JLMC

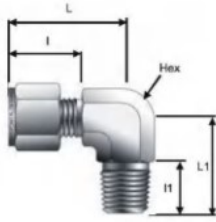

Ordering Number	Dimensions-Inch						
	Tube OD	BSP Pipe Threaded	L	L1	I	I1	HEX
JLMC4T2R	1/4	1/8	1.06	0.74	0.77	0.98	1/2
JLMC4T4R	1/4	1/4	1.06	0.93	0.77	0.56	9/16
JLMC4T6R	1/4	3/8	1.17	1.04	0.88	0.56	11/16
JLMC4T8R	1/4	1/2	1.25	1.31	0.96	0.75	13/16
JLMC5T4R	5/16	1/4	1.13	0.97	0.84	0.56	9/16
JLMC6T4R	3/8	1/4	1.20	1.01	0.91	0.56	5/8
JLMC6T6R	3/8	3/8	1.23	1.13	0.97	0.56	11/16
JLMC8T6R	1/2	3/8	1.42	1.12	1.02	0.56	13/16
JLMC8T8R	1/2	1/2	1.42	1.31	1.02	0.75	13/16

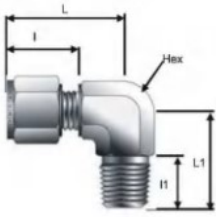

Ordering Number	Dimensions-MM						
	Tube OD	BSP Pipe Threaded	L	L1	I	I1	HEX
JLMC3M2R	3	1/8	23.6	17.8	17.0	9.7	7/16
JLMC4M2R	4	1/8	25.4	18.8	18.8	9.7	1/2
JLMC4M4R	4	1/4	24.6	23.4	18.8	14.2	1/2
JLMC6M2R	6	1/8	27.0	18.8	19.6	9.7	1/2
JLMC6M4R	6	1/4	27.0	23.4	19.6	14.2	1/2
JLMC6M6R	8	3/8	29.8	36.2	22.4	14.2	11/16
JLMC6M8R	6	1/2	31.8	33.0	24.4	19.0	13/16
JLMC8M2R	8	1/8	28.8	19.8	21.3	9.7	9/16
JLMC8M4R	8	1/4	28.8	24.4	21.3	14.2	9/16
JLMC8M6R	8	3/8	30.6	26.2	23.1	14.2	11/16
JLMC8M8R	8	1/2	32.7	33.0	25.2	19.0	13/16
JLMC10M2R	10	3/4	31.5	21.6	23.9	9.7	11/16
JLMC10M4R	10	1/4	31.5	26.2	23.9	14.2	11/16
JLMC10M6R	10	3/8	31.5	26.2	23.9	14.2	11/16
JLMC10M8R	10	1/2	33.5	33.0	23.9	19.0	13/16
JLMC12M4R	12	1/4	36.0	28.2	25.9	14.2	13/16
JLMC12M6R	12	3/8	36.0	28.2	25.9	14.2	13/16
JLMC12M8R	12	1/2	36.0	33.0	25.9	19.0	13/16
JLMC12M12R	12	3/4	39.8	36.8	29.7	19.0	1-1/16
JLMC15M8R	15	1/2	38.0	35.1	27.9	19.0	15/16
JLMC16M6R	16	3/8	38.0	30.2	27.9	14.2	15/16
JLMC16M8R	16	1/4	38.0	35.1	27.9	19.0	15/16
JLMC16M12R	16	3/8	39.8	36.8	29.7	19.0	1-1/16
JLMC18M18R	18	1/2	39.8	36.8	29.7	19.0	1-1/16
JLMC18M12R	18	3/4	39.8	36.8	29.7	19.0	1-1/16
JLMC20M12R	20	3/4	44.6	41.7	34.5	19.0	1-3/8
JLMC25M12R	25	3/4	49.1	41.7	36.8	19.0	1-3/8
JLMC25M16R	25	3/4	49.1	46.5	36.8	23.9	1-3/8

直角可调接头 Positionable SAE Male Elbow JL-0G

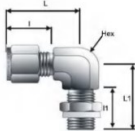

Ordering Number	Dimensions-Inch						
	Tube OD	BSP Threaded	L	L1	I	I1	HEX
JL4T2G-0G	1/4	1/8	1.06	1.04	0.77	0.81	9/16
JL4T4G-0G	1/4	1/4	1.14	1.27	0.85	0.83	9/16
JL6T4G-0G	3/8	1/4	1.20	1.27	0.85	0.83	9/16
JL6T6G-0G	3/8	3/8	1.31	1.46	1.02	0.83	3/4
JL8T4G-0G	1/2	1/4	1.50	1.38	1.10	0.83	7/8
JL8T6G-0G	1/2	3/8	1.50	1.46	1.10	0.85	7/8
JL8T8G-0G	1/2	1/2	1.50	1.71	1.10	1.09	7/8
JL12T8G-0G	3/4	1/2	1.57	1.81	1.17	1.09	1-1/16
JL12T12G-0G	3/4	3/4	1.57	1.92	1.17	1.20	1-1/16

安装说明:

- 1、将可调端组装到内螺纹接头中，直到垫圈接触端口表面
- 2、通过将接头从内螺纹接头中旋出（不超过一圈），将接头定位到所需方向
- 3、握住接头体，拧紧锁紧螺母，直到垫圈接触端口表面。

直角卡套对焊接头
Male Pipe Weld Elbow
JLCW

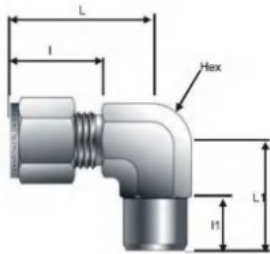

Ordering Number	Dimensions-Inch					
	Tube OD	L	L1	I	I1	HEX
JLCW2T2T	1/4	0.92	0.63	0.66	0.16	5/16
JLCW3T3T	3/16	0.98	0.69	0.72	0.20	7/16
JLCW4T4T	1/4	1.06	0.84	0.78	0.25	9/16
JLCW6T6T	3/8	1.31	1.08	1.02	0.34	3/4
JLCW8T8T	1/2	1.42	1.14	1.02	0.41	3/4
JLCW10T10T	5/8	1.57	1.35	1.17	0.49	1-1/16
JLCW12T12T	3/4	1.57	1.39	1.17	0.50	1-1/16
JLCW16T16T	1	1.93	1.84	1.65	0.56	1-5/8

Ordering Number	Dimensions-Inch					
	Tube OD	Pipe Size	L	L1	I	HEX
JLCW2T2P	1/8	1/8	0.93	0.70	0.67	7/16
JLCW3T2P	3/16	1/8	1.01	0.74	0.74	7/16
JLCW4T2P	1/4	1/8	1.06	0.74	0.77	7/16
JLCW4T4P	1/4	1/4	1.10	0.97	0.78	9/16
JLCW6T4P	3/8	1/4	1.20	1.00	0.91	5/8
JLCW8T6P	1/2	3/8	1.42	1.11	1.02	13/16
JLCW8T8P	1/2	1/2	1.42	1.30	1.02	7/8
JLCW10T8P	5/8	1/2	1.50	1.39	1.10	15/16
JLCW12T12P	3/4	3/4	1.57	1.45	1.17	1-1/16
JLCW16T12P	1	3/4	1.94	1.64	1.45	1-5/16
JLCW16T16P	1	1	1.94	1.64	1.45	1-3/8

直角内丝卡套接头
NPT (F) Threaded Elbow
JLCF

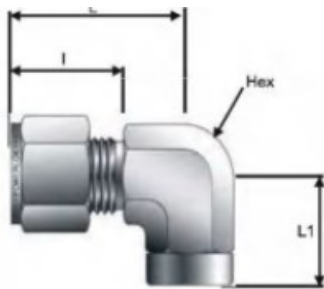

Ordering Number	Dimensions-Inch					
	Tube OD	Pipe Size	L	L1	I	HEX
JLCF2T2N	1/8	1/8	0.97	0.75	0.71	9/16
JLCF3T2N	3/16	1/8	1.00	0.75	0.74	9/16
JLCF4T2N	1/4	1/8	1.06	0.75	0.77	9/16
JLCF4T4N	1/4	1/4	1.20	0.88	0.91	11/16
JLCF5T2N	5/16	1/8	1.13	0.75	0.84	9/16
JLCF5T4N	5/16	1/4	1.24	0.88	0.94	11/16
JLCF6T2N	3/8	1/8	1.20	0.75	0.91	5/8
JLCF6T4N	3/8	1/4	1.26	0.88	0.97	11/16
JLCF6T6N	3/8	3/8	1.31	0.88	1.02	13/16
JLCF8T4N	1/2	1/4	1.42	0.88	1.02	13/16
JLCF8T6N	1/2	3/8	1.42	0.88	1.02	13/16
JLCF8T8N	1/2	1/2	1.53	1.13	1.13	1
JLCF12T8N	3/4	1/2	1.57	1.13	1.17	1-1/16
JLCF12T12N	3/4	3/4	1.76	1.25	1.36	1-3/8
JLCF16T12N	1	3/4	1.93	1.25	1.45	1-3/8
JLCF16T16N	1	1	2.02	1.50	1.53	1-5/8

Ordering Number	Dimensions-MM					
	Tube OD	NPT Pipe Size	L	L1	I	HEX
JLC4M2N	4	1/8	29.6	16.1	23.0	14.0
JLC6M2N	6	1/8	31.3	17.7	23.8	14.0
JLC6M4N	6	1/4	36.1	17.7	28.6	19.0
JLC6M6N	6	3/8	37.7	17.7	30.2	22.0
JLC6M8N	6	1/2	42.5	17.7	35.0	27.0
JLC8M2N	8	1/8	32.1	18.6	24.6	14.0
JLC8M4N	8	1/4	36.9	18.6	29.4	19.0
JLC8M6N	8	3/8	35.5	18.6	31.0	22.0
JLC10M4N	10	1/4	37.8	19.5	30.2	19.0
JLC10M6N	10	3/8	39.4	19.5	31.8	22.0
JLC10M8N	10	1/2	44.1	19.5	36.5	27.0
JLC12M4N	12	1/4	41.9	22.0	31.8	22.0
JLC12M6N	12	3/8	41.9	22.0	31.8	22.0
JLC12M8N	12	1/2	46.6	22.0	36.5	27.0

三通中间接头

Union Tee JT

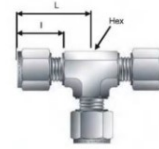
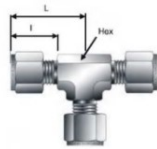

Ordering Number	Dimensions-Inch			
	Tube OD	L	I	HEX
JT1T	1/16	0.70	0.55	3/8
JT2T	1/8	0.88	0.62	3/8
JT3T	3/16	1.00	0.74	7/16
JT4T	1/4	1.06	0.77	1/2
JT5T	5/16	1.13	0.84	5/8
JT6T	3/8	1.20	0.91	5/8
JT8T	1/2	1.42	1.02	13/16
JT10T	5/8	1.50	1.10	1
JT12T	3/4	1.57	1.17	1-1/16
JT14T	7/8	1.76	1.36	1-3/8
JT16T	1	1.93	1.45	1-3/8
JT20T	1-1/4	2.61	1.75	1-5/8
JT24T	1-1/2	3.06	2.00	1-7/8
JT32T	2	4.22	2.75	2-13/16

Ordering Number	Dimensions-MM			
	Tube OD	L	I	HEX
JT3M	3	22.3	15.7	3/8
JT4M	4	25.4	18.8	1/2
JTJT6M	6	27.0	19.6	1/2
JT8M	8	28.8	21.3	5/8
JT10M	10	31.5	23.9	11/16
JT12M	12	36.0	25.9	13/16
JT14M	14	38.1	28.0	1
JT15M	15	38.0	27.9	1
JT16M	16	38.0	27.9	1
JT18M	18	39.8	29.7	1-1/16
JT20M	20	44.6	34.5	1-3/8
JT22M	22	44.6	34.5	1-3/8
JT25M	25	49.1	36.8	1-3/8

四通中间接头

Union Cross JX

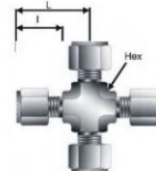
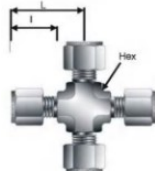

Ordering Number	Dimensions-Inch			
	Tube OD	L	I	HEX
JX2T	1/8	0.98	0.62	7/16
JX3T	3/16	0.96	0.70	1/2
JX4T	1/4	1.06	0.76	1/2
JX5T	5/16	1.17	0.88	5/8
JX6T	3/8	1.20	0.91	5/8
JX8T	1/2	1.42	1.02	13/16
JX10T	5/8	1.53	1.13	1-1/16
JX12T	3/4	1.57	1.16	1-1/16
JX14T	7/8	1.76	1.36	1-5/16
JX16T	1	1.93	1.45	1-5/16

Ordering Number	Dimensions-MM			
	Tube OD	L	I	HEX
JX3M	3	22.3	15.7	7/16
JX4M	4	25.4	18.8	1/2
JX6M	6	27.0	19.6	1/2
JX8M	8	29.9	22.4	5/8
JX10M	10	33.5	25.9	13/16
JX12M	12	36.0	25.9	13/16
JX16M	16	37.0	26.9	15/16
JX18M	18	38.3	28.2	1-1/16

三通变径接头

Reducing Union Tee JTR

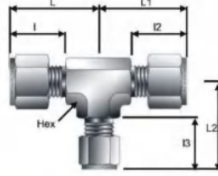

Ordering Number	Dimensions-Inch									
	Tube OD1	Tube OD2	Tube OD3	L1	L2	L3	I1	I2	I3	HEX
JT4T4T2T	1/4	1/4	1/8	1.05	1.05	0.96	0.76	0.76	0.70	1/2
JT6T6T4T	3/8	3/8	1/4	1.20	1.20	1.14	0.91	0.91	0.85	5/8
JT6T4T6T	3/8	1/4	3/8	1.14	1.14	1.20	0.91	0.85	0.91	5/8
JT6T4T4T	3/8	1/4	1/4	1.14	1.14	1.14	0.91	0.85	0.85	5/8
JT8T8T6T	1/2	1/2	3/8	1.42	1.42	1.31	1.02	1.02	1.02	13/16
JT8T8T4T	1/2	1/2	1/4	1.42	1.42	1.25	1.02	1.02	0.96	13/16
JT8T6T8T	1/2	3/8	1/2	1.42	1.31	1.42	1.02	1.02	1.02	13/16
JT8T4T8T	1/2	1/4	1/2	1.42	1.25	1.42	1.02	0.96	1.02	13/16
JT8T6T6T	1/2	3/8	3/8	1.42	1.31	1.31	1.02	1.02	1.02	13/16
JT8T4T4T	1/2	1/4	1/4	1.42	1.25	1.25	1.02	0.96	0.96	13/16
JT10T10T8T	5/8	5/8	1/2	1.53	1.53	1.53	1.13	1.13	1.13	7/8
JT10T10T6T	5/8	5/8	3/8	1.53	1.53	1.53	1.13	1.13	1.13	7/8
JT10T8T8T	5/8	1/2	1/2	1.53	1.53	1.53	1.13	1.13	1.13	7/8
JT10T10T6T	5/8	5/8	3/8	1.53	1.53	1.42	1.13	1.13	1.13	7/8
JT10T6T6T	5/8	3/8	3/8	1.53	1.42	1.42	1.13	1.13	1.13	7/8
JT10T6T8T	5/8	3/8	1/2	1.53	1.42	1.53	1.13	1.13	1.13	7/8
JT12T12T10	3/4	3/4	5/8	1.56	1.56	1.56	1.16	1.16	1.16	1-1/16
JT12T12T8T	3/4	3/4	1/2	1.56	1.56	1.56	1.16	1.16	1.16	1-1/16
JT12T12T6T	3/4	3/4	3/8	1.56	1.56	1.45	1.16	1.16	1.16	1-1/16
JT12T12T4T	3/4	3/4	1/4	1.56	1.56	1.39	1.16	1.16	1.16	1-1/16
JT12T10T10T	3/4	5/8	5/8	1.56	1.56	1.56	1.16	1.16	1.16	1-1/16
JT12T8T8T	3/4	1/2	1/2	1.56	1.56	1.56	1.16	1.16	1.16	1-1/16
JT12T6T6T	3/4	3/8	3/8	1.56	1.45	1.45	1.16	1.16	1.16	1-1/16
JT12T10T8T	3/4	5/8	1/2	1.56	1.56	1.56	1.16	1.16	1.16	1-1/16
JT12T10T6T	3/4	5/8	3/8	1.56	1.56	1.45	1.16	1.16	1.16	1-1/16
JT12T8T6T	3/4	1/2	3/8	1.56	1.56	1.45	1.16	1.16	1.16	1-1/16
JT14T14T6T	7/8	7/8	3/8	1.76	1.76	1.65	1.36	1.36	1.36	1-3/8
JT14T14T4T	7/8	7/8	1/4	1.76	1.76	1.59	1.36	1.36	1.30	1-3/8
JT14T12T12T	7/8	3/4	3/4	1.76	1.76	1.76	1.36	1.36	1.36	1-3/8
JT14T12T8T	7/8	3/4	1/2	1.76	1.76	1.76	1.36	1.36	1.36	1-3/8
JT14T12T6T	7/8	3/4	3/8	1.76	1.76	1.65	1.36	1.36	1.36	1-3/8
JT14T106T	7/8	5/8	3/8	1.76	1.76	1.65	1.36	1.36	1.36	1-3/8
JT14T8T12T	7/8	1/2	3/4	1.76	1.76	1.76	1.36	1.36	1.36	1-3/8
JT16T16T12T	1	1	3/4	1.94	1.94	1.76	1.45	1.45	1.36	1-3/8
JT16T16T10T	1	1	5/8	1.94	1.94	1.76	1.45	1.45	1.36	1-3/8
JT16T16T8T	1	1	1/2	1.94	1.94	1.76	1.45	1.45	1.36	1-3/8
JT16T16T6T	1	1	3/8	1.94	1.94	1.65	1.45	1.45	1.36	1-3/8
JT16T16T4T	1	1	1/4	1.94	1.94	1.59	1.45	1.45	1.30	1-3/8
JT16T12T16T	1	3/4	1	1.94	1.76	1.94	1.45	1.36	1.45	1-3/8
JT16T14T4T	1	7/8	7/8	1.94	1.76	1.76	1.45	1.36	1.36	1-3/8
JT16T14T12T	1	7/8	3/4	1.94	1.76	1.76	1.45	1.36	1.36	1-3/8
JT16T14T8T	1	7/8	1/2	1.94	1.76	1.76	1.45	1.36	1.36	1-3/8
JT16T14T6T	1	7/8	3/8	1.94	1.76	1.65	1.45	1.36	1.36	1-3/8
JT16T14T4T	1	7/8	1/4	1.94	1.76	1.59	1.45	1.36	1.30	1-3/8
JT16T16T14T	1	1	7/8	1.94	1.94	1.76	1.45	1.45	1.36	1-3/8
JT16T12T10T	1	3/4	5/8	1.94	1.76	1.76	1.45	1.36	1.36	1-3/8
JT16T12T8T	1	3/4	1/2	1.94	1.76	1.76	1.45	1.36	1.36	1-3/8
JT16T10T6T	1	5/8	3/8	1.94	1.76	1.65	1.45	1.36	1.36	1-3/8
JT16T8T16T	1	1/2	1	1.94	1.76	1.94	1.45	1.36	1.45	1-3/8
JT16T8T8T	1	1/2	1/2	1.94	1.76	1.76	1.45	1.36	1.36	1-3/8
JT16T8T6T	1	1/2	3/8	1.94	1.76	1.65	1.45	1.36	1.36	1-3/8
JT16T8T4T	1	1/2	1/4	1.94	1.76	1.59	1.45	1.36	1.30	1-3/8
JT16T6T6T	1	3/8	3/8	1.94	1.65	1.65	1.45	1.36	1.36	1-3/8

三通终端卡套接头
Male Run Tee JTTM

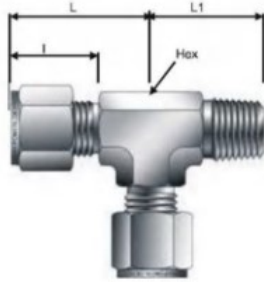

Ordering Number	Dimensions-Inch					
	Tube OD	NPT Thread	L	L1	I	HEX
JTTMT-2T2T2N	1/8	1/8	0.93	0.71	0.66	7/16
JTTMT-4T4T2N	1/4	1/8	1.06	0.74	0.77	1/2
JTTMT-4T4T4N	1/4	1/4	1.06	0.93	0.77	1/2
JTTMT-5T5T2N	5/16	1/8	1.17	0.82	0.88	5/8
JTTMT-5T5T4N	5/16	1/4	1.17	1.01	0.88	5/8
JTTMT-6T6T4N	3/8	1/4	1.20	1.01	0.91	5/8
JTTMT-6T6T6N	3/8	3/8	1.31	1.12	1.02	13/16
JTTMT-8T8T6N	1/2	3/8	1.42	1.12	1.02	13/16
JTTMT-8T8T8N	1/2	1/2	1.42	1.31	1.02	7/8
JTTMT-12T12T12N	3/4	3/4	1.57	1.46	1.17	1-1/16
JTTMT-16T16T12N	1	3/4	1.94	1.65	1.45	1-3/8
JTTMT-16T16T16N	1	1	1.94	1.84	1.45	1-3/8

Ordering Number	Dimensions-Inch					
	Tube OD	NPT Thread	L	L1	I	HEX
JTTMT-6M2R6M	6	1/8	27.0	18.0	19.6	1/2
JTTMT-6M4R6M	6	1/4	27.0	23.4	19.6	1/2
JTTMT-8M2R8M	8	1/8	29.9	20.8	22.4	5/8
JTTMT-8M4R8M	8	1/4	29.9	25.4	22.4	5/8
JTTMT-10M4R10M	10	1/4	33.5	28.2	25.9	13/16
JTTMT-10M6R10M	10	3/8	33.5	33.0	25.9	13/16
JTTMT-12M6R12M	12	3/8	36.0	28.2	25.9	13/16
JTTMT-12M8R12M	12	1/2	36.0	33.0	25.9	13/16

三通终端卡套接头
Male Run Tee JTTM

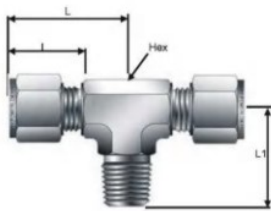

Ordering Number	Dimensions-Inch					
	Tube OD	NPT Thread	L	L1	I	HEX
JTTMT-2T2T2N	1/8	1/8	0.93	0.71	0.66	7/16
JTTMT-4T4T2N	1/4	1/8	1.06	0.74	0.77	1/2
JTTMT-4T4T4N	1/4	1/4	1.06	0.93	0.77	1/2
JTTMT-5T5T2N	5/16	1/8	1.17	0.82	0.88	5/8
JTTMT-5T5T4N	5/16	1/4	1.17	1.01	0.88	5/8
JTTMT-6T6T4N	3/8	1/4	1.20	1.01	0.91	5/8
JTTMT-6T6T6N	3/8	3/8	1.31	1.12	1.02	13/16
JTTMT-8T8T6N	1/2	3/8	1.42	1.12	1.02	13/16
JTTMT-8T8T8N	1/2	1/2	1.42	1.31	1.02	7/8
JTTMT-12T12T12N	3/4	3/4	1.57	1.46	1.17	1-1/16
JTTMT-16T16T12N	1	3/4	1.94	1.65	1.45	1-3/8
JTTMT-16T16T16N	1	1	1.94	1.84	1.45	1-3/8

Ordering Number	DimensionsMM					
	Tube OD	NPT Thread	L	L1	I	HEX
JTTMT-6M6M2R	6	1/8	27.0	18.0	19.6	1/2
JTTMT-6M6M4R	6	1/4	27.0	23.4	19.6	1/2
JTTMT-8M8M2R	8	1/8	29.9	20.8	22.4	5/8
JTTMT-8M8M4R	8	1/4	29.9	25.4	22.4	5/8
JTTMT-10M10M4R	10	1/4	33.5	28.2	25.9	13/16
JTTMT-10M10M6R	10	3/8	33.5	33.0	25.9	13/16
JTTMT-12M12M6R	12	3/8	36.0	28.2	25.9	13/16
JTTMT-12M12M8R	12	1/2	36.0	33.0	25.9	13/16

三通内丝卡套接头
NPT (F) Threaded Tee JTTFTF

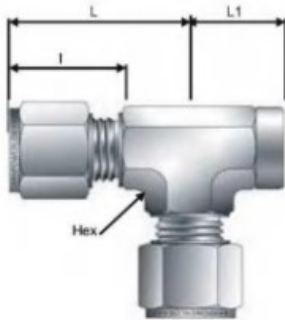

Ordering Number	Dimensions-Inch					
	Tube OD	NPT Thread	L	L1	I	HEX
JTTFT-T2T2N2T-F	1/8	1/8	0.96	0.75	0.70	1/2
JTTFT-T4T2N4T-F	1/4	1/8	1.06	0.75	0.77	1/2
JTTFT-T4T4N4T-F	1/4	1/4	1.17	0.88	0.88	11/16
JTTFT-T5T2N5T-F	5/16	1/8	1.17	0.75	0.88	5/8
JTTFT-T6T4N6T-F	3/8	1/4	1.23	0.88	0.94	11/16
JTTFT-T8T4N8T-F	1/2	1/4	1.42	0.88	1.02	13/16
JTTFT-T8T6N8T-F	1/2	3/8	4.42	0.88	1.02	7/8
JTTFT-T8T8N8T-F	1/2	1/2	1.53	1.13	1.13	1
JTTFT-T12T12N12T-F	3/4	3/4	1.76	1.25	1.36	1-3/8
JTTFT-T16T12N16T-F	1	3/4	1.93	1.25	1.45	1-3/8
JTTFT-T16T16N16T-F	1	1	2.02	1.50	1.65	1-3/8

Ordering Number	Dimensions-MM					
	Tube OD	NPT Thread	L	L1	I	HEX
JTTFT-T6M2R6M-F	6	1/8	27.0	19.0	19.6	1/2
JTTFT-T6M4R6M-F	6	1/4	29.8	22.4	22.4	1/2
JTTFT-T8M2R8M-F	8	1/8	29.9	19.0	22.4	5/8
JTTFT-T10M4R10M-F	10	1/4	33.5	22.4	25.9	5/8
JTTFT-T12M4R12M-F	12	1/4	36.0	22.4	25.9	13/16
JTTFT-T12M6R12M-F	12	3/8	36.0	22.4	25.9	13/16
JTTFT-T12M8R12M-F	12	1/2	38.8	28.5	28.7	13/16
JTTFT-T16M8R16M-F	16	1/2	39.8	28.4	29.7	13/16

三通内丝卡套接头
NPT (F) Threaded Tee JTTTF

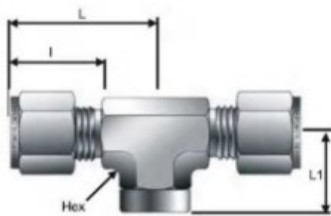

Ordering Number	Dimensions-Inch					
	Tube OD	NPT Thread	L	L1	I	HEX
JTTTF-2T2T2N-F	1/8	1/8	0.96	0.75	0.70	1/2
JTTTF-4T4T2N-F	1/4	1/8	1.06	0.75	0.77	1/2
JTTTF-4T4T4N-F	1/4	1/4	1.17	0.88	0.88	11/16
JTTTF-5T5T2N-F	5/16	1/8	1.17	0.75	0.88	5/8
JTTTF-6T6T4N-F	3/8	1/4	1.23	0.88	0.94	11/16
JTTTF-8T8T4N-F	1/2	1/4	1.42	0.88	1.02	13/16
JTTTF-8T8T6N-F	1/2	3/8	1.42	0.88	1.02	7/8
JTTTF-8T8T8N-F	1/2	1/2	1.53	1.13	1.13	1
JTTTF-12T12T12N-F	3/4	3/4	1.76	1.25	1.36	1-3/8
JTTTF-16T16T12N-F	1	3/4	1.93	1.25	1.45	1-3/8
JTTTF-16T16T16N-F	1	1	2.02	1.50	1.65	1-3/8

Ordering Number	Dimensions-MM					
	Tube OD	NPT Thread	L	L1	I	HEX
JTTTF-6M6M2R-F	6	1/8	27.0	19.0	19.6	1/2
JTTTF-6M6M4R-F	6	1/4	29.8	22.4	22.4	1/2
JTTTF-8M8M2R-F	8	1/8	29.9	19.0	22.4	5/8
JTTTF-8M8M4R-F	10	1/4	33.5	22.4	25.9	5/8
JTTTF-10M10M4R-F	12	1/4	36.0	22.4	25.9	13/16
JTTTF-10M10M6R-F	12	3/8	36.0	22.4	25.9	13/16
JTTTF-12M12M6R-F	12	1/2	38.8	28.5	28.7	13/16
JTTTF-12M12M8R-F	16	1/2	39.8	28.4	29.7	13/16

法兰转卡套接头

J-LOK

Flanges ASME/ANSI B16.5

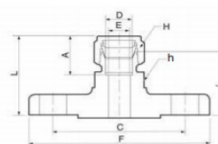

Ordering Number	Tube OD		ANSI Flange NPS	ANSI Class	E	Wrench Flat h	A	I	L	C	F
	In	Mm									
J4TRF8-150LB	1/4	6.35	1/2	150	4.82	23.81	15.24	33.52	40.89	60.45	88.9
J4TRF16-150LB			1	150	4.82	23.81	15.24	36.35	43.71	79.2	108
J6TRF8-150LB	3/8	9.52	1/2	150	4.82	23.81	16.76	34.85	42.21	60.45	88.9
J6TRF8-300LB			1/2	300	7.11	23.81	16.76	38.1	45.46	66.54	95.25
J6TRF16-150LB			1	150	7.11	23.81	16.76	37.85	45.21	79.2	108
J8TRF8-150LB	1/2	12.7	1/2	150	10.41	23.81	22.85	30.05	45.21	60.45	88.9
DF-8TRF8-300LB			1/2	300	10.41	23.81	22.86	37.85	48.01	66.54	95.25
J8TRF8-1500LB			1/2	1500	40.41	23.81	22.86	46.05	56.21	82.6	121
J8TRF16-150LB			1	150	40.41	23.81	22.86	38.1	48.26	79.24	48.26
J8TRF32-150LB			2	150	10.41	23.81	22.86	42.92	53.08	42.92	53.08
J12TRF16-150LB	3/4	19.05	1	150	15.74	31.75	24.38	40.13	50.29	79.24	107.95
J12TRF16-900LB			1	900	15.74	31.75	24.38	46.05	56.21	101.6	149
J16TRF16-150LB	1	25.4	1	150	22.35	34.92	31.24	48.26	60.45	79.24	107.95
J24TRF32-150LB	1-1/2	38.1	2	150	34.03	53.97	50.03	59.18	86.36	120.65	152.4
J32TRF32-150LB	2	50.8	2	150	45.97	69.85	67.56	67.05	104.39	120.65	152.4

J-LOK Flanges ASME/ANSI B16.5

Ordering Number	Tube O. D. D	DIN Flange Size, DN	DIN CLASS	E	Wrench Flat h	A	I	L	C	F
J6MRF25M-40	6mm	25	40	4.8	20	15.3	40.1	47.5	85.0	115.0
J12MRF15M-40	12mm	15	40	9.5	20	22.8	38.4	48.5	65.0	95.0
J12MRF25M-40		25	40	9.5	20	22.8	40.4	50.5	85.0	115.0
J12MRF50M-40		50	40	9.5	20	22.8	45.2	55.3	125.0	165.0
J18MRF15M-40	18mm	15	40	15.1	32	24.4	41.7	51.8	65.0	95.0
J18MRF15M-40		25	40	15.1	32	24.4	43.7	53.8	85.0	115.0
J25MRF25M-40	25mm	25	40	21.8	35	31.3	51.8	64.0	85.0	115.0
J38MRF50M-40	38mm	50	40	33.7	55	49.4	62.7	90.4	125.0	165.0
J-50MRF50M-40	50mm	50	40	45.2	70	65.0	66.3	103.0	125.0	165.0

J-LOK Flanges ASME/ANSI B16.5

Ordering Number	Tube OD		JIS Flange Size, dn	JISI Class	E	Wrench Flat h	A	I	L	C	F
	In	Mm									
J4TJIS15-10K	1/4	6.35	15	10K	4.82	23.81	15.24	34.79	42.16	70.10	94.99
J6TJIS15-10K	3/8	9.52	15	10K	7.11	23.81	16.76	36.32	43.68	70.70	94.99
J8TJIS15-10K	1/2	12.7	15	10K	10.41	23.81	22.86	36.32	46.48	70.70	94.99
J12TJIS15-10K	3/4	19.05	15	10K	15.74	31.75	24.38	38.35	48.51	70.70	94.99
J16TJIS25-10K	1	25.4	25	10K	22.35	34.91	31.24	48.76	60.96	89.91	124.96
J32TJIS50-10K	2	50.8	50	10K	45.97	69.85	67.56	64.51	101.85	119.88	154.94
J12MJIS15-10K	12mm		15	10K	9.5	20	22.8	36.3	46.5	70.0	95.0
J18MJIS15-10K	18mm		15	10K	15.1	32	24.4	38.4	48.5	70.0	95.0
J25MJIS25-10K	25mm		25	10K	21.8	35	31.3	48.8	61.0	90.0	125.0

螺母
Nut JN

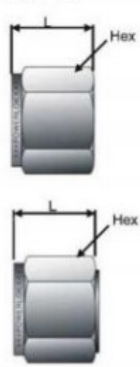

Ordering Number	Tube OD	Dimensions-Inch	
		L	HEX
JN-1	1/16	0.31	5/16
JN-2	1/8	0.47	7/16
JN-3	3/16	0.47	1/2
JN-4	1/4	0.50	9/16
JN-5	5/16	0.53	5/8
JN-6	3/8	0.56	11/16
JN-8	1/2	0.69	7/8
JN-10	5/8	0.69	1
JN-12	3/4	0.69	1-1/8
JN-14	7/8	0.69	1-1/4
JN-16	1	0.81	1-1/2
JN-20	1-1/4	1.25	1-7/8
JN-24	1-1/2	1.50	2-1/4
JN-32	2	2.06	3

Ordering Number	Tube OD	Dimensions-Inch	
		L	HEX
JN-2M	2	11.9	12.0
JN-3M	3	11.9	12.0
JN-4M	4	11.9	12.0
JN-6M	6	12.7	14.0
JN-8M	8	13.5	16.0
JN-10M	10	15.1	19.0
JN-12M	12	17.5	22.0
JN-14M	14	17.5	25.0
JN-15M	15	17.5	25.0
JN-16M	16	17.5	25.0
JN-18M	18	17.5	30.0
JN-20M	20	17.5	32.0
JN-22M	22	17.5	32.0
JN-25M	25	20.6	38.0

前卡套
Front Ferrule JFF



Ordering Number	Tube OD
JFF-1	1/16
JFF-2	1/8
JFF-3	3/16
JFF-4	1/4
JFF-5	5/16
JFF-6	3/8
JFF-8	1/2
JFF-10	5/8
JFF-12	3/4
JFF-14	7/8
JFF-16	1
JFF-20	1-1/4
JFF-24	1-1/2
JFF-32	2

后卡套

Back Ferrule JFB



Ordering Number	Tube OD
JFB-2M	2
JFB-3M	3
JFB-4M	4
JFB-6M	6
JFB-8M	8
JFB-10M	10
JFB-12M	12
JFB-14M	14
JFB-15M	15
JFB-16M	16
JFB-18M	18
JFB-20M	20
JFB-22M	22
JFB-25M	25

撑管
Tube Insert JI



Ordering Number	Dimensions-Inch		
	Tube OD	Tube ID	Tube WALL
JI3T2T	3/16	0.125	0.031
JI4T2T	1/4	0.125	0.061
JI4T3T	1/4	0.188	0.031
JI6T3T	3/8	0.188	0.094
JI6T4T	3/8	0.250	0.062
JI8T4T	1/2	0.250	0.125
JI8T6T	1/2	0.375	0.062

Ordering Number	Dimensions-Inch		
	Tube OD	Tube ID	Tube WALL
JI6M4M	6	4	1.0
JI8M6M	8	6	1.0
JI10M6M	10	6	2.0
JI10M8M	10	8	1.0
JI12M8M	12	8	2.0
JI12M10M	12	10	1.0
JI15M10M	15	10	2.5

J-LOK VCR 接头系列 Metal GasketFace SealFittings

JVCR-M (公螺母)
Male Nut



Head Size	Ordering Number	ID	A	F	M
1/4	JVCR-N04M	9.10	18.30	15.90	9/16-18UNF
1/2	JVCR-N08M	15.50	20.00	23.80	7/8-14UNF
3/4	JVCR-N12M	22.60	25.40	33.30	11/4-18UNF
1	JVCR-N16M	30.50	30.20	41.30	11/2-20UNF

JVCR-F (母螺母)
Female Nut

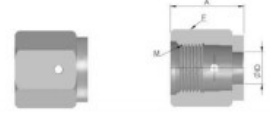

Head Size	Ordering Number	ID	A	F
1/4	JVCR-N04F	9.10	20.75	19.05
1/2	JVCR-N08F	15.50	22.50	26.90
3/4	JVCR-N12F	22.60	28.50	38.10
1	JVCR-N16F	30.50	34.00	44.50

JVCR-GR (垫片固定器总成)
Gasket Retainer Assembly



Head Size	Ordering Number	OD	ID	A
1/4	JVCR-04GR	11.85	5.50	0.70
1/2	JVCR-08GR	19.30	11.70	0.70
3/4	JVCR-12GR	28.0	16.80	0.70
1	JVCR-16GR	34.20	22.60	0.70

JVCR-VR (非固定式垫片)
Silver Plated Nonretained



Head Size	Ordering Number	OD	ID	A
1/4	JVCR-04VR	11.90	5.60	0.70
1/2	JVCR-08VR	19.80	11.20	0.70
3/4	JVCR-12VR	29.00	16.80	0.70
1	JVCR-16VR	35.60	22.30	0.70

VCR-VP (螺帽)
Plug

Plug



Head Size	Ordering Number	A	F
1/4	JVCR-04VP	23.20	15.90
1/2	JVCR-08VP	27.30	23.80
3/4	JVCR-12VP	36.30	33.30
1	JVCR-16VP	38.60	41.30

JVCR-04VCP (插头)
Cap

Cap

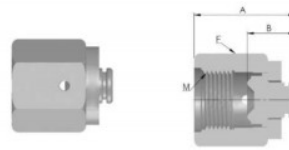

Head Size	Ordering Number	A	B	F
1/4	JVCR-04VCP	22.90	11.30	19.10
1/2	JVCR-08VCP	25.60	12.20	27.00
3/4	JVCR-12VCP	32.80	13.70	38.10
1	JVCR-16VCP	39.40	16.00	44.50

Long Gland 加长焊管本体

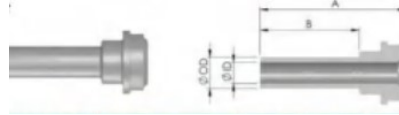

Head Size	Tube Size (OD)	Ordering Number	OD	ID	A	B
1/4	1/4	JVCR-04TBL	6.35	4.35	43.20	19.05
3/8	3/8	JVCR-06TBL	9.53	7.53	45.50	19.05
1/2	1/2	JVCR-08TBL	12.70	10.22	45.50	19.05
1/2	1/4	JVCR-08-04TBL	6.35	4.35	45.50	19.05
3/4	3/4	JVCR-12TBL	19.05	15.75	51.60	19.05
1	1	JVCR-16TBL	25.40	22.10	58.90	20.00

Long GlandL 加长变径焊管本体

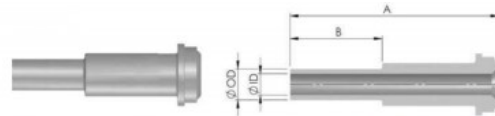

Head Size	Tube Size (OD)	Ordering Number	OD	ID	A	B
1/4	1/4	JVCR-04TB	6.35	4.35	28.00	19.05
3/8	3/8	JVCR-06TB	9.53	7.53	28.50	19.05
1/2	1/2	JVCR-08TB	12.70	10.22	28.50	19.05
1/2	1/4	JVCR-08-04V	6.35	4.35	28.50	19.05
3/4	3/4	JVCR-12TB	19.05	15.75	34.50	19.05
1	1	JVCR-16TB	25.40	22.10	38.60	20.00

Male NPT Connector 外丝转 VCR JVCR-N-V

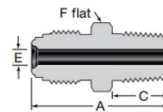

NPT Size	VCR Size	Ordering Number	Dimensions				Working Pressure		
			A	C	E	F	Ni	SS	Cu
Dimensions, in (mm)							Psig (bar)		
1/16	1/8	JVCR-01N-02V	1.07 (27.2)	0.38 (9.6)	0.09 (2.3)Ⓞ	3/8	9000 (620)	9000 (620)	7200 (496)
1/8	1/8	JVCR-02N-02V	1.07 (27.2)	0.38 (9.6)	0.09 (2.3)Ⓞ	7/16	9000 (620)	9000 (620)	7200 (496)
	1/4	JVCR-02N-04V	1.31 (33.3)			0.18 (4.6)	5/8	8000 (551)	10000 (689)
1/4	1/4	JVCR-04N-04V	1.49 (37.8)	0.56 (14.2)	0.18 (4.6)	5/8	8000 (551)	10000 (689)	6400 (440)
	1/2	JVCR-04N-08V	1.65 (41.9)			0.28 (7.1)	15/16	3500 (241)	4300 (296)
3/8	1/2	JVCR-06N-08V	1.65 (41.9)	0.56 (14.2)	0.38 (9.6)	15/16	3500 (241)	4300 (296)	2800 (192)
1/2	1/2	JVCR-08N-08V	1.84 (46.7)	0.75 (19.1)	0.40 (10.2)	15/16	3500 (241)	4300 (296)	2800 (192)
3/4	3/4	JVCR-12N-12V	21.9 (55.6)	0.75 (19.1)	0.62 (15.7)	15/16	3000 (206)	3700 (254)	2400 (165)
1	1	JVCR-16N-16V	24.47 (62.7)	0.94 (23.9)	0.87 (22.1)	15/8	2400 (165)	3000 (206)	1900 (130)

J-LOK Tube Fitting Connector VCR 外丝转卡套 JVCR-T-V

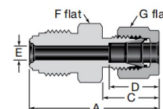

Tube Size	VCR Size	Ordering Number	Dimensions						Working Pressure		
			A	C	D	E	F	G	Ni	SS	Cu
Dimensions, in (mm)									Psig (bar)		
1/8	1/4	JVCR-02T-04V	1.53 (38.9)	0.60 (15.2)	0.50 (12.7)	0.09 (2.3)	5/8	7/16	8000 (551)	10000 (689)	6400 (440)
1/4	1/4	JVCR-04T-04V	1.62 (41.1)	0.70 (17.8)	0.60 (15.2)	0.18 (4.6)	5/8	9/16	8000 (551)	10000 (689)	6400 (440)
3/8	1/2	JVCR-06T-08V	1.84 (46.7)	0.76 (19.3)	0.66 (16.8)	0.28 (7.1)	15/16	11/16	3500 (241)	4300 (296)	2800 (192)
1/2	1/2	JVCR-08T-08V	19.5 (49.5)	0.86 (21.8)	0.90 (22.9)	0.40 (10.2)	15/16	7/8	3500 (241)	4300 (296)	800 (192)

微焊焊接接头（自动焊接）

Micro-R-union JBW

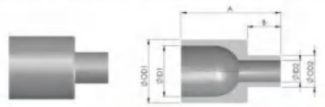

Size (OD)		Ordering Numbe)	OD		ID		A	B
OD1	OD2		OD1	OD2	ID1	ID2		
3/8	1/4	JBW-06W-04W	9.53	6.35	7.53	4.35	19.05	6.35
1/2	1/4	JBW-08W-04W	12.70	6.35	10.22	4.35	19.05	6.35
1/2	3/8	JBW-08W-06W	12.70	9.53	10.22	7.53	19.05	6.35

Micro Elbow JLBW

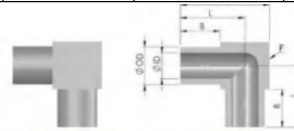

Size (OD)	Ordering Numbe)	OD	ID	A	B	L	F
1/4	JBWL-04	6.35	4.35	14.29	6.35	10.32	7.94
3/8	JBWL-06	9.53	7.53	17.46	6.35	11.91	11.11
1/2	JBWL-08	12.70	10.22	20.64	6.35	13.50	14.29
3/4	JBWL-12	19.05	15.75	27.00	6.35	16.68	20.65
6M	JBWL-6M	6.00	4.00	14.29	6.35	10.32	7.94
8M	JBWL-8M	8.00	6.00	17.46	6.35	11.91	11.11
10M	JBWL-10M	10.00	8.00	17.46	6.35	11.91	11.11
12M	JBWL-12M	12.00	10.00	20.64	6.35	13.50	14.29

Micro Tee JTBW

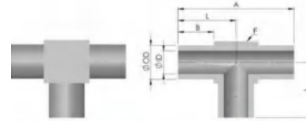

Size(OD)	Ordering Numbe)	OD	ID	A	B	L	F
1/4	JBWT-04	6.35	4.35	14.29	6.35	10.32	7.94
3/8	JBWT-06	9.53	7.53	17.46	6.35	11.91	11.11
1/2	JBWT-08	12.70	10.22	20.64	6.35	13.50	14.29
3/4	JBWT-12	19.05	15.75	27.00	6.35	16.68	20.65
6M	JBWT-6M	6.00	4.00	14.29	6.35	10.32	7.94
8M	JBWT-8M	8.00	6.00	17.46	6.35	11.91	11.11
10M	JBWT-10M	10.00	8.00	17.46	6.35	11.91	11.11
12M	JBWT-12M	12.00	10.00	20.64	6.35	13.50	14.29

Long Reducing Union JBW-L

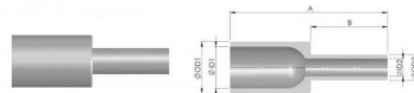

Size (OD)		Ordering Numbe)	OD		ID		A	B
OD1	OD2		OD1	OD2	ID1	ID2		
3/8	1/4	JBW-06L04L	9.53	6.35	7.53	4.35	39.00	19.00
1/2	1/4	JBW-08L04L	12.70	6.35	10.22	4.35	39.00	19.00
1/2	3/8	JBW-08L06L	12.70	9.53	10.22	7.53	39.00	19.00
3/4	1/4	JBW-12L04L	19.05	6.35	15.75	4.53	42.90	19.00
3/4	3/8	JBW-12L06L	19.05	9.53	15.75	7.53	42.90	19.00
3/4	1/2	JBW-12L08L	19.05	12.70	15.75	10.22	42.90	19.00
1	1/4	JBW-16L04L	25.40	6.35	22.10	4.35	44.50	19.00
1	3/8	JBW-16L06L	25.40	9.53	22.10	7.53	44.50	19.00
1	1/2	JBW-16L08L	25.40	12.70	22.10	10.22	44.50	19.00
1	3/4	JBW-16L12L	25.40	19.05	22.10	15.75	44.50	23.00

Long Tee JBWT-L

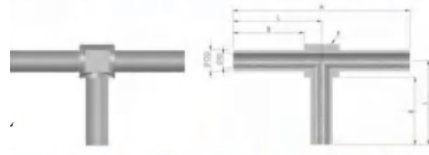

Size (OD))	Ordering Numbe)	OD	ID	A	B	L	F
1/4	JBWT-04L	6.35	4.35	50.00	20.00	25.00	10.00
3/8	JBWT-06L	9.53	7.53	52.00	20.00	26.00	12.50
1/2	JBWT-08L	12.70	10.22	56.00	20.00	28.00	16.00
3/4	JBWT-12L	19.05	15.75	68.00	23.00	34.00	22.00
1	JBWT-16L	25.40	22.10	75.00	23.00	37.50	28.50

Long Eibow JBWL-L

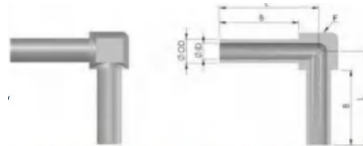

Size (OD))	Ordering Numbe)	OD	ID	B	L	F
1/4	JBWL-04L	6.35	4.35	20.00	25.00	10.00
3/8	JBWL-06L	9.53	7.53	20.00	26.00	12.50
1/2	JBWL-08L	12.70	10.22	20.00	28.00	16.00
3/4	JBWL-12L	19.05	15.75	23.00	34.00	22.00
1	JBWL-16L	25.40	22.10	23.00	37.50	28.50

Long Reducing Tee JBWTR-L

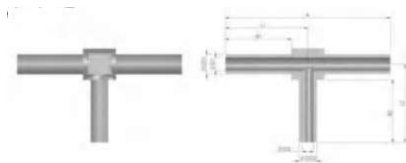

Size (OD))		Ordering Numbe)	OD		ID		A	B1	L1	B2	L2	F
OD1	OD2		OD1	OD2	ID1	ID2						
3/8	1/4	JBWTR-06L04L	9.53	6.35	7.53	4.35	52.00	20.00	26.00	20.00	26.00	12.50
1/2	1/4	JBWTR-08L04L	12.70	6.35	10.22	4.35	26.00	20.00	28.00	20.00	28.00	16.00
1/2	3/8	JBWTR-08L06L	12.70	9.53	10.22	7.53	56.00	20.00	28.00	20.00	28.00	16.00
3/4	1/4	JBWTR-12L04L	19.05	6.35	15.75	4.35	68.00	23.00	34.00	20.00	31.00	22.00
3/4	3/8	JBWTR-12L06L	19.05	9.53	15.75	7.53	68.00	23.00	34.00	20.00	31.00	22.00
3/4	1/2	JBWTR-12L08L	19.05	12.70	15.75	10.22	68.00	23.00	34.00	20.00	31.00	22.00
1	1/4	JBWTR-16L04L	25.40	6.35	22.10	4.35	75.00	23.50	37.50	20.00	34.00	28.50
1	3/8	JBWTR-16L06L	25.40	9.53	22.10	7.53	75.00	23.50	37.50	20.00	34.00	28.50
1	1/2	JBWTR-16L08L	25.40	12.70	22.10	10.22	75.00	23.50	37.50	20.00	34.00	28.50
1	3/4	JBWTR-16L12L	25.40	19.05	22.10	15.75	75.00	23.50	37.50	23.00	34.00	28.50

J- LOK 快速接头 (Quick Connect)



技术尺寸参数:

型号	订货代号	两端连接尺寸	订货代号 1	订货代号 2	流量		部件总长度尺寸				总长度尺寸	
			母头	公头	Cv-B	Cv-A	公头		母头			
							mm	inch	mm	inch	mm	inch
JQA	JQA-2T	1/8" ' ' OD J-LOK	JQCB-2F	JQCA-2T	0.1	0.1	59.0	2.32	70.4	2.77	57.5	2.26
	JQA-4T	1/4" ' ' OD J-LOK	JQCB-4F	JQCA-4T	0.3	0.2	59.9	2.36	61.5	2.42	58.4	2.30
	JQA-6MM	6mm J-LOK	JQCB-6MM	JQCA-6MM	0.3	0.2	59.9	2.36	61.5	2.42	58.4	2.30
	JQA-8MM	8mm J-LOK	JQCB-8MM	JQCA-8MM	0.3	0.2	63.8	2.51	65.4	2.57	62.3	2.45
	JQA-2M	1/8" ' ' Mde NPT	JQCB-2F	JQCA-2M	0.3	0.2	52.5	2.07	54.1	2.13	51.0	2.01
	JQA-4M	1/4" ' ' Mde NPT	JQCB-4M	JQCA-4M	0.3	0.2	56.3	2.22	57.9	2.28	54.9	2.16
	JQA-2PT	1/8" ' ' Male BSPT	JQCB-2MPT	JQCA-2MPT	0.3	0.2	52.5	2.07	54.1	2.13	51.0	2.01
	JQA-4PT	1/4" ' ' Male BSPT	JQCB-4MPT	JQCA-4MPT	0.3	0.2	56.3	2.22	57.9	2.28	54.9	2.16
	JQA-2G	1/8" ' ' Male BSPP	JQCB-2G	JQCA-2G	0.3	0.2	51.0	2.01	52.6	2.07	51.0	2.01
	JQA-4G	1/4" ' ' Male BSPP	JQCB-4G	JQCA-4G	0.3	0.2	57.4	2.26	58.9	2.32	61.5	2.42
	JQA-2F	1/8" ' ' Female NPT	JQCB-2F	JQCA-2F	0.2	0.2	51.0	2.01	52.6	2.07	54.9	2.16
	JQA-4F	1/4" ' ' Female NPT	JQCB-4F	JQCA-4F	0.3	0.2	57.4	2.26	58.9	2.32	61.5	2.42
	JQA-2G	1/8" ' ' Female BSPP	JQCB-2G	JQCA-2G	0.2	0.2	51.0	2.01	52.6	2.07	54.9	2.16
	JQA-4G	1/4" ' ' Female BSPP	JQCB-4G	JQCA-4G	0.3	0.2	57.4	2.26	58.9	2.32	61.5	2.42
	JQA-4PT	1/4" ' ' Female BSPT	JQCB-4PT	JQCA-4PT	0.3	0.2	57.4	2.26	58.9	2.32	61.5	2.42
JQB-04T	1/4" ' ' OD J-LOK	JQCB-4T	JQCA-04T	0.3	0.2	69.6	2.74	71.1	2.8	67.8	2.67	
JQB	JQB-6T	3/8" ' ' OD J-LOK	JQCB-6T	JQCA-6T	0.9	0.6	64.0	2.52	67.2	2.64	65.5	2.58
	JQB-10MM	10mm J-LOK	JQCB-10MM	JQCA-10MM	0.9	0.6	67.3	2.65	70.5	2.77	68.1	2.68
	JQB-4M	1/4" ' ' Male NPT	JQCB-4M	JQCA-4M	0.9	0.6	58.9	2.32	62.1	2.44	60.5	2.38
	JQB-6M	3/8" ' ' Male NPT	JQCB-6M	JQCA-6M	0.8	0.5	59.7	2.35	62.9	2.47	60.5	2.38
	JQB-4PT	1/4" ' ' Male BSPT	JQCB-4PT	JQCA-4PT	0.9	0.5	58.9	2.32	62.1	2.44	60.5	2.38
	JQB-6PT	3/8" ' ' Male BSPT	JQCB-6PT	JQCA-6PT	0.8	0.5	59.7	2.35	62.9	2.47	60.5	2.38
	JQB-4G	1/4" ' ' Male BSPP	JQCB-4G	JQCA-4G	0.9	0.5	59.7	2.35	62.9	2.47	60.5	2.38
	JQB-6G	3/8" ' ' Male BSPP	JQCB-6G	JQCA-6G	0.8	0.5	59.7	2.35	62.9	2.47	65.3	2.57
	JQB-4F	1/4" ' ' Female NPT	JQCB-4F	JQCA-4F	0.9	0.5	59.7	2.35	62.9	2.47	64.5	2.54
	JQB-6F	3/8" ' ' Female NPT	JQCB-6F	JQCA-6F	0.8	0.5	59.7	2.35	62.9	2.47	65.3	2.57
	JQB-4G	1/4" ' ' Female BSPP	JQCA-4G	JQCA-4G	0.9	0.5	59.7	2.35	62.9	2.47	64.5	2.54
	JQB-6G	3/8" ' ' Female BSPP	JQCB-6G	JQCA-6G	0.8	0.5	59.7	2.35	62.9	2.47	65.3	2.57
	JQB-4PT	1/4" ' ' Female BSPT	JQCB-4PT	JQCA-4PT	0.9	0.5	59.7	2.35	62.9	2.47	64.5	2.54
	JQB-6PT	3/8" ' ' Female BSPT	JQCB-6PT	JQCA-6PT	0.8	0.5	59.7	2.35	62.9	2.47	65.3	2.57
	JQB-PT	3/8" ' ' OD J-LOK	JQCB-6T	JQCA-6T	1.1	0.5	74.2	2.92	77.3	3.04	75.7	2.98
JQC	JQC-8T	1/2" ' ' OD J-LOK	JQCB-8T	JQCA-8T	2.2	1.5	75.2	2.96	80.2	3.16	78.5	3.09
	JQC-12MM	1/2" MM J-LOK	JQCB-12MM	JQCA-12MM	2.2	1.5	75.2	2.96	80.2	3.16	78.5	3.09
	JQC-8M	1/2" ' ' Male NPT	JQCB-8M	JQCA-8M	2	1.3	72.3	2.84	77.2	3.04	75.5	2.97
	JQC-8PT	1/2" ' ' Male BSPT	JQCB-8PT	JQCA-8PT	2	1.3	72.3	2.84	77.2	3.04	75.5	2.97
	JQC-8G	1/2" ' ' Male BSPP	JQCB-8G	JQCA-8G	2	1.3	71.7	2.82	76.7	3.02	69.9	2.75
	JQC-8F	1/2" ' ' Female NPT	JQCB-8F	JQCA-8F	2	1.3	71.7	2.82	76.7	3.02	81.9	3.22
	JQC-8G	1/2" ' ' Female BSPP	JQCB-8G	JQCA-8G	2	1.3	71.7	2.82	76.7	3.02	81.9	3.22
	JQC-8PT	1/2" ' ' Female BSPT	JQCB-8PT	JQCA-8PT	2	1.33	71.7	2.82	76.7	3.02	81.9	3.22
JQC-8T	1/2" ' ' OD J-LOK	JQCB-8T	JQCA-8T	2.2	1.5	87.2	3.43	92.1	3.63	90.4	3.56	

钢瓶接头 (Cylinder connection)

G5/8RH/G5/8LH W21.8RH/W21.8LH 系列

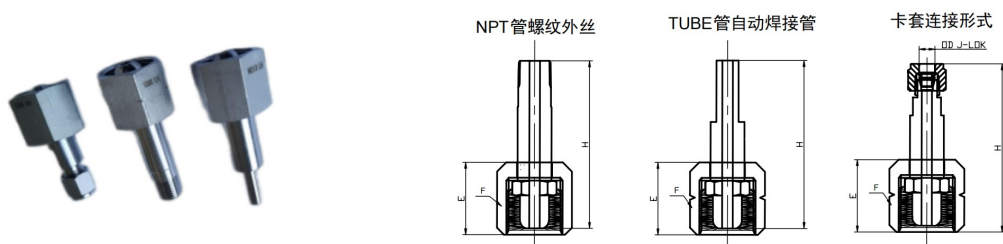

订货代号	阀出口	连接形式	H	E	F 六角尺寸
			mm	mm	mm
J-G5/8RH-04NM	G5/8-RH	1/4" Male NPT	70	24	27
J-G5/8RH-04BW		1/4" Auto Tube Wled	61		
J-G5/8RH-04T		1/4" J-LOK	50		
J-G5/8RH-06MM		6mm J-LOK,	50		
J-G5/8RH-02T		1/8" J-LOK	50		
J-G5/8RH-03MM		3mm J-LOK	50		
J-G5/8LH-04NM	G5/8-LH	1/4" Male NPT	70	24	27
J-G5/8LH-04BW		1/4" Auto Tube Wled	61		
J-G5/8LH-04T		1/4" J-LOK	50		
J-G5/8LH-06NM		6mm J-LOK	50		
J-G5/8LH-02T		1/8" J-LOK	50		
J-G5/8LH-03NM		3mm J-LOK	50		
J-W21.8RH-04NM	W21.8-RH	1/4" Male NPT	70	24	27
J-W21.8RH-04BW		1/4" Auto Tube Wled	61		
J-W21.8RH-04T		1/4" J-LOK	50		
J-W21.8RH-06NM		6mm J-LOK	50		
J-W21.8RH-02T		1/8" J-LOK	50		
J-W21.8RH-03NM		3mm J-LOK	50		
J-W21.8LH-04NM	W21.8-LH	1/4" Male NPT	70	24	27
J-W21.8LH-04BW		1/4" Auto Tube Wled	61		
J-W21.8LH-04T		1/4" J-LOK	50		
J-W21.8LH-06NM		6mm J-LOK	50		
J-W21.8LH-02T		1/8" J-LOK	50		
J-W21.8LH-03NM		3mm J-LOK	50		

钢瓶接头 (Cylinder connection)

GGA 系列

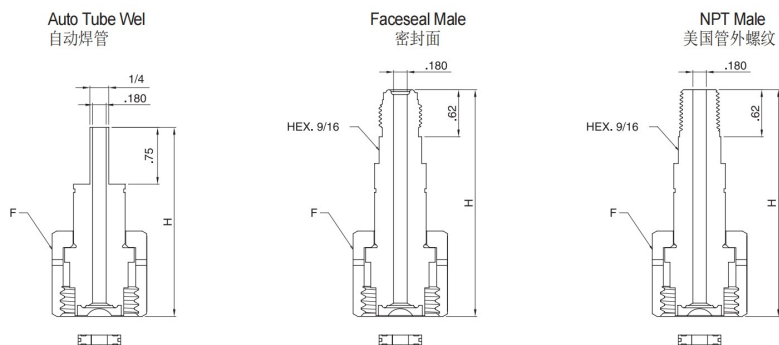

技术要求尺寸参数:

JCGA 编号	连接形式	订货代号	H 总长度尺寸		F 六角尺寸
			in	mm	
JCGA632	1/4 Auto Tube Weld	JCGA632-04TBW	2.50	63.5	1-1/4
	1/4 Faceseal Male	JCGA632-04VM	3.00	76.2	
	1/4 NPT Male	JCGA632-04NM	3.00	76.2	
JCGA634	1/4 Auto Tube Weld	JCGA634-04TBW	2.50	63.5	1-1/4
	1/4 Faceseal Male	JCGA634-04VM	3.00	76.2	
	1/4 NPT Male	JCGA634-04NM	3.00	76.2	
JCGA636	1/4 Auto Tube Weld	JCGA636-04TBW	2.50	63.5	1-1/4
	1/4 Faceseal Male	JCGA636-04VM	3.00	76.2	
	1/4 NPT Male	JCGA636-04NM	3.00	76.2	
JCGA638	1/4 Auto Tube Weld	JCGA638-04TBW	2.50	63.5	1-1/4
	1/4 Faceseal Male	JCGA638-04VM	3.00	76.2	
	1/4 NPT Male	JCGA638-04NM	3.00	76.2	
JCGA640	1/4 Auto Tube Weld	JCGA640-04TBW	2.50	63.5	1-1/4
	1/4 Faceseal Male	JCGA640-04VM	3.00	76.2	
	1/4 NPT Male	JCGA640-04NM	3.00	76.2	
JCGA642	1/4 Auto Tube Weld	JCGA642-04TBW	2.50	63.5	1-1/4
	1/4 Faceseal Male	JCGA642-04VM	3.00	76.2	
	1/4 NPT Male	JCGA642-04NM	3.00	76.2	
JCGA712	1/4 Auto Tube Weld	JCGA712-04TBW	2.50	63.5	1-3/8
	1/4 Faceseal Male	JCGA712-04VM	3.00	76.2	
	1/4 NPT Male	JCGA712-04NM	3.00	76.2	
JCGA714	1/4 Auto Tube Weld	JCGA714-04TBW	2.50	63.5	1-3/8
	1/4 Faceseal Male	JCGA714-04VM	3.00	76.2	
	1/4 NPT Male	JCGA714-04NM	3.00	76.2	
JCGA716	1/4 Auto Tube Weld	JCGA716-04TBW	2.50	63.5	1-3/8
	1/4 Faceseal Male	JCGA716-04VM	3.00	76.2	
	1/4 NPT Male	JCGA716-04NM	3.00	76.2	

钢瓶接头 (Cylinder connection)

GGA 系列

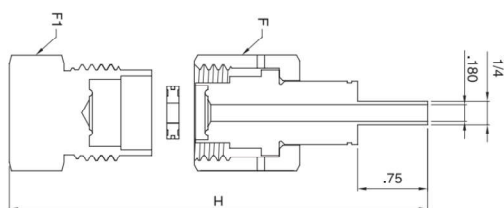

技术要求、尺寸参数:

JCGA 编号	订货代号	H 总长度尺寸		F 六角尺寸	F1 六角尺寸
		in	mm		
JCGA632-P	JCGA632-04TBW-P	3.4	86.4	1-1/4	1-1/8
JCGA634-P	JCGA634-04TBW-P	3.4	86.4	1-1/4	1-1/8
JCGA636-P	JCGA636-04TBW-P	3.4	86.4	1-1/4	1-1/8
JCGA638-P	JCGA638-04TBW-P	3.4	86.4	1-1/4	1-1/8
JCGA640-P	JCGA640-04TBW-P	3.4	86.4	1-1/4	1-1/8
JCGA642-P	JCGA642-04TBW-P	3.4	86.4	1-1/4	1-1/8
JCGA712-P	JCGA712-04TBW-P	3.4	86.4	1-3/8	1-1/8
JCGA714-P	JCGA714-04TBW-P	3.4	86.4	1-3/8	1-1/8
JCGA716-P	JCGA716-04TBW-P	3.4	86.4	1-3/8	1-1/8
JCGA718-P	JCGA718-04TBW-P	3.4	86.4	1-3/8	1-1/8
JCGA720-P	JCGA720-04TBW-P	3.4	86.4	1-3/8	1-1/8
JCGA722-P	JCGA722-04TBW-P	3.4	86.4	1-3/8	1-1/8
JCGA724-P	JCGA724-04TBW-P	3.4	86.4	1-3/8	1-1/8
JCGA726-P	JCGA726-04TBW-P	3.4	86.4	1-3/8	1-1/8
JCGA728-P	JCGA728-04TBW-P	3.4	86.4	1-3/8	1-1/8

钢瓶接头 (Cylinder connection)

GGA 系列

技术要求、尺寸参数:

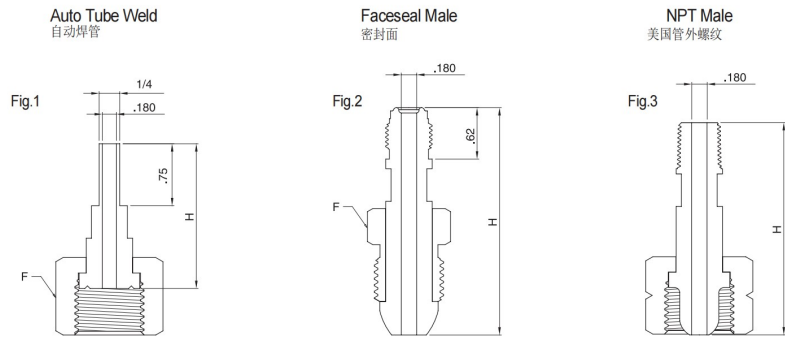

JCGA 编号	连接形式	订货代号	H 总长度		F 六角尺寸
			in	mm	
JCGA170	1/4 Auto Tube Weld	JCGA170-04TBW	1-1/4	31.7	11/16
	1/8 NPT Male	JCGA170-02NM	1-1/4	31.7	
JCGA180	1/4 Auto Tube Weld	JCGA180-04TBW	1-1/4	31.7	3/4
	1/8 NPT Male	JCGA180-02NM	1-3/4	44.4	
JCGA290	1/4 Auto Tube Weld	JCGA290-04TBW	2-5/8	66.6	1
	1/8 NPT Male	JCGA290-02NM	2-1/4	57.1	
JCGA296	1/4 Auto Tube Weld	JCGA296-04TBW	2-5/8	66.6	7/8
	1/4 Faceseal Male	JCGA296-04VM	2-3/4	69.8	
	1/4 NPT Male	JCGA296-04NM	3-1/2	88.9	
JCGA320	1/4 Auto Tube Weld	JCGA320-04TBW	1-3/4	44.4	1-1/8
	1/4 Faceseal Male	JCGA320-04VM	2-3/4	69.8	
	1/4 NPT Male	JCGA320-04NM	3-1/2	88.9	
JCGA326	1/4 Auto Tube Weld	JCGA326-04TBW	2-1/4	57.1	1-1/8
	1/4 Faceseal Male	JCGA326-04VM	2-1/4	57.1	
	1/4 NPT Male	JCGA326-04NM	3	76.2	
JCGA330	1/4 Auto Tube Weld	JCGA330-04TBW	1-3/4	44.4	1-1/8
	1/4 Faceseal Male	JCGA330-04VM	1-3/4	44.4	
	1/4 NPT Male	JCGA330-04NM	2-1/2	63.5	
JCGA346	1/4 Auto Tube Weld	JCGA346-04TBW	2-5/16	58.7	1-1/8
	1/4 Faceseal Male	JCGA346-04VM	2-1/4	57.1	
	1/4 NPT Male	JCGA346-04NM	3	76.2	
JCGA350	1/4 Auto Tube Weld	JCGA350-04TBW	2-5/16	58.7	1-1/8
	1/4 Faceseal Male	JCGA350-04VM	2-1/4	57.1	
	1/4 NPT Male	JCGA350-04NM	3	76.2	

钢瓶接头(Cylinder connection)

GGA 系列

技术要求、尺寸参数:

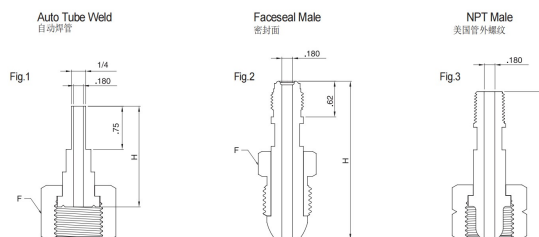

JCGA 编号	连接形式	订货代号	H 总长度尺寸		F 六角尺寸
			in	Mm	
JCGA510	1/4 Auto Tube Weld	JCGA510-04TBW	2-5/8	66.7	1-1/8
	1/4 Faceseal Male	JCGA510-04VM	2-3/4	69.8	
	1/4 NPT Male	JCGA510-04NM	3-1/2	88.9	
JCGA540	1/4 Auto Tube Weld	JCGA540-04TBW	2-1/4	57.1	1-1/8
	1/4 Faceseal Male	JCGA540-04VM	2-1/4	57.1	
	1/4 NPT Male	JCGA540-04NM	3	76.2	
JCGA580	1/4 Auto Tube Weld	JCGA580-04TBW	2-5/8	66.7	1-1/8
	1/4 Faceseal Male	JCGA580-04VM	2-3/4	69.8	
	1/4 NPT Male	JCGA580-04NM	3-1/2	88.9	
JCGA590	1/4 Auto Tube Weld	JCGA590-04TBW	2-1/2	63.5	1-1/8
	1/4 Faceseal Male	JCGA590-04VM	2-3/4	69.8	
	1/4 NPT Male	JCGA590-04NM	3-1/2	88.9	
JCGA660	1/4 Auto Tube Weld	JCGA660-04TBW	2-3/16	55.6	1-1/4
	1/4 Faceseal Male	JCGA660-04VM	1-7/8	47.6	
	1/4 NPT Male	JCGA660-04NM	2-1/2	63.5	
JCGA670	1/4 Auto Tube Weld	JCGA670-04TBW	2-3/16	55.6	1-1/4
	1/4 Faceseal Male	JCGA670-04VM	1-7/8	47.6	
	1/4 NPT Male	JCGA670-04NM	2-1/2	63.5	
JCGA678	1/4 Auto Tube Weld	JCGA678-04TBW	2-1/2	63.5	1-1/4
	1/4 Faceseal Male	JCGA678-04VM	2	50.8	
	1/4 NPT Male	JCGA678-04NM	2-1/2	63.5	
JCGA679	1/4 Auto Tube Weld	JCGA679-04TBW	2-1/2	63.5	1-1/4
	1/4 Faceseal Male	JCGA679-04VM	2	50.8	
	1/4 NPT Male	JCGA679-04NM	3	76.2	

钢瓶接头 (Cylinder connection)

GGA 系列

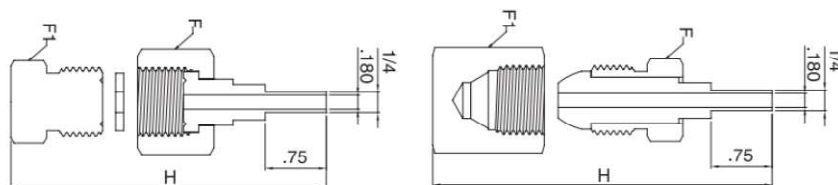

技术要求、尺寸参数:

JCGA 编号	连接形式	H 总长度尺寸		F 六角尺寸	F1 六角尺寸
		in	mm		
JCGA296	JCGA296-04TBW-P	3.03	77	7/8	1-1/8
JGA320	JCGA320-04TBW-P	2.96	75.2	1-1/8	1
JCGA326	JCGA326-04TBW-P	3.01	76.5	1-1/8	1
JCGA330	JCGA330-04TBW-P	2.96	75.2	1-1/8	1
JCGA346	JCGA346-04TBW-P	2.97	75.4	1-1/8	1
JCGA350	JCGA350-04TBW-P	2.96	75.2	1-1/8	1
JCGA510	JCGA510-04TBW-P	3.03	77	1-1/8	1-1/4
JCGA540	JCGA540-04TBW-P	2.96	75.2	1-1/8	1
JCGA580	JCGA580-04TBW-P	3.03	77	1-1/8	1-1/4
JCGA590	JCGA590-04TBW-P	3.03	77	1-1/8	1-1/4
JCGA660	JCGA660-04TBW-P	2.96	75.2	1-1/4	1-1/8
JCGA670	JCGA670-04TBW-P	2.96	75.2	1-1/4	1-1/8
JCGA678	JCGA678-04TBW-P	3.08	78.2	1-1/4	1-1/8
JCGA679	JCGA679-04TBW-P	2.96	75.2	1-1/4	1-1/8

钢瓶接头(Cylinder connection)

DIN/JIS 系列

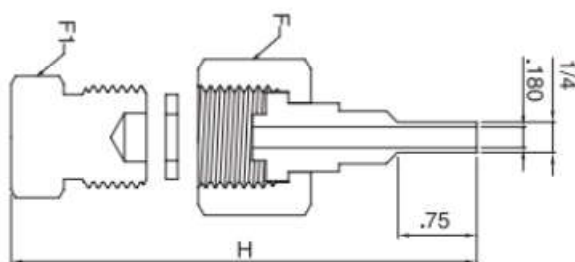

技术要求、尺寸参数:

JDIN 编号	连接形式	H 总长度尺寸		F 六角尺寸	F1 六角尺寸
		in	mm		
JDIN1	JDIN1-04BTW -P	2.96	75.2	1-1/4	1-1/4
JDIN5	JDIN5-04BTW -P	3.09	78.5	1-1/4	1-1/4
JDIN6	JDIN6-04BTW -P	2.96	75.2	1-1/4	1-1/4
JDIN8	JDIN8-04BTW -P	3.09	78.5	1-1/4	1-1/4
JDIN11	JDIN11-04BTW -P	2.88	73.2	7/8	11/16
JDIN14	JDIN14-04BTW -P	2.88	73.2	1-1/16	7/8

JJIS 编号	连接形式	H 总长度尺寸		F 六角尺寸	F1 六角尺寸
		in	mm		
JJIS22R	JJIS22R-04TBW-P	3.25	82.6	1-1/4	1-1/4
JJIS22L	JJIS22L-04TBW-P	3.25	82.6	1-1/4	1-1/4
JJIS26R	JJIS26R-04TBW-P	3.14	79.8	1-1/4	1-1/4
JJIS26L	JJIS26L-04TBW-P	3.14	79.8	1-1/4	1-1/4

垫片

金属密封垫片-JG

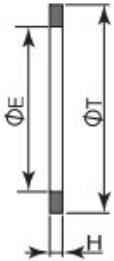

ISO 平行螺纹规格	基本订购号	尺寸: mm		
		T	E	H
1/4	JG-04	10.7	7.6	1.8
3/8	JG-06	14.2	8.6	2.3
1/2	JG-08	17.8	9.1	2.5

公制螺纹规格	基本订购号	尺寸: mm		
		T	E	H
M10x1	JG-10MM	8.3	3.3	1.5
M12x1.5	JG-12MM	9.7	5.4	2.0
M14x1.5	JG-14MM	11.7	6.4	
M16x1.5	JG-16MM	13.7	8.4	
M18x1.5	JG-18MM	15.7	10.2	
M20x1.5	JG-20MM	17.6	11.4	
M22x1.5	JG-22MM	19.6	13.4	
M24x1.5	JG-24MM	21.6	14.8	
M27x2	JG-27MM	24.0	13.9	2.5
M30x2	JG-30MM	27.0	19.5	
M33x2	JG-33MM	30.2	21.5	
M36x2	JG-36MM	33.2	23.5	
M39x2	JG-39MM	33.0	24.5	
M42x2	JG-42MM	36.0	29.5	
M45x2	JG-45MM	41.9	30.0	
M48x2	JG-48MM	44.9	32.5	

组合垫片 JZH

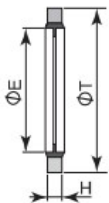

ISO 平行螺纹规格	基本订购号	尺寸: mm		
		T	E	H
1/8	JZH-02	16.0	10.4	20
1/4	JZH-04	20.6	13.7	
3/8	JZH-06	23.9	17.3	
1/2	JZH-08	28.7	21.6	2.5
3/4	JZH-12	35.1	26.9	
1	JZH-16	42.9	33.8	

嵌入式垫片-JED

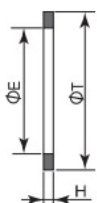

ISO 平行螺纹规格	基本订购号	尺寸: mm		
		T	E	H
1/8	JED-02	15.0	9.9	1.0
1/4	JED-04	19.1	13.2	2.0
3/8	JED-06	23.1	16.8	
1/2	JED-08	26.9	21.1	2.5
3/4	JED-12	33.0	26.7	
1	JED-16	40.1	33.2	

不锈钢无缝管

Tube 管系列



材料及材料标准

等级	UNS	ASTM	ASME
316/316L	S31600/S31603	A213/A269	SA213
304/304L	S30400/S30403	A213/A269	SA213

处理工艺

类别	酸洗	机械抛光	光亮退火	电解抛光
标记	AP	MP	BA	EP

规格、尺寸、压力等级

管子外径 in	攻城壁厚 in	订购规格	公称长度 m	压力额定值 psig
1/8	0.028	φ1/8"x0.028"x6M	6	8500
1/4	0.035	φ1/4"x0.035"x6M		5100
	0.049	φ1/4"x0.049"x6M		7500
	0.065	φ1/4"x0.065"x6M		10200
3/8	0.035	φ3/8"x0.035"x6M		3300
	0.049	φ3/8"x0.049"x6M		4800
	0.065	φ3/8"x0.065"x6M		6500
1/2	0.035	φ1/2"x0.035"x6M		2600
	0.049	φ1/2"x0.049"x6M		3700
	0.065	φ1/2"x0.065"x6M		5100
5/8	0.065	φ5/8"x0.065"x6M		4000
3/4	0.065	φ3/4"x0.065"x6M		3300
1	0.083	φ1"x0.083"x6M		3100
1-1/4	0.095	φ1-1/4"x0.095"x6M		2800
	0.120	φ1-1/4"x0.120"x6M		3600
1-1/2	0.120	φ1-1/2"x0.120"x6M		3000
	0.134	φ1-1/2"x0.134"x6M		3400
2	0.134	φ2"x0.134"x6M		2500
	0.188	φ2"x0.188"x6M	3600	

pipe 管系列

材料及材料标准



等级	UNS	ASTM	ASME
316/316L	S31600/S31603	A213/A269	SA213
304/304L	S30400/S30403	A213/A269	SA213

处理工艺

类别	酸洗	机械抛光	光亮退火	电解抛光
标记	AP	MP	BA	EP

规格、尺寸、压力等级

管规格	公称外径 mm	壁厚等级	公称壁厚 mm	压力额定值 Psig (bar)
1/8	10.29	Sch10	1.25	3940 (272)
		Sch40	1.73	5750 (397)
		Sch80	2.41	8700 (600)
1/4	13.72	Sch10	1.65	3960 (273)
		Sch40	2.24	5620 (387)
		Sch80	3.02	8130 (560)
3/8	17.15	Sch10	1.65	3110 (215)
		Sch40	2.31	4540 (313)
		Sch80	3.2	6660 (459)
1/2	21.34	Sch5	1.65	2470 (170)
		Sch10	2.11	3220 (222)
		Sch40	2.77	4370 (301)
		Sch80	3.73	6190 (427)
		Sch160	4.75	-
3/4	26.67	Sch5	1.65	1960 (135)
		Sch10	2.11	2540 (175)
		Sch40	2.87	3550 (245)
		Sch80	3.91	5040 (348)
		Sch160	5.54	-
1	33.4	Sch5	1.65	1550 (107)
		Sch10	2.77	2680 (185)
		Sch40	3.38	3330 (229)
		Sch80	4.55	4650 (320)
		Sch160	6.35	-
1-1/4	42.16	Sch5	1.65	1230 (85)
		Sch10	2.77	2110 (146)
		Sch40	3.56	2760 (190)
		Sch80	4.85	3890 (268)
		Sch160	6.35	-
1-1/2	48.26	Sch5	1.65	1070 (74)
		Sch10	2.77	1830 (126)
		Sch40	3.68	2460 (170)
		Sch80	5.08	3520 (243)
		Sch160	7.14	-
2	60.33	Sch5	1.65	840 (58)
		Sch10	2.77	1430 (99)
		Sch40	3.91	2060 (142)
		Sch80	5.54	2990 (206)
		Sch160	8.74	-
2-1/2	73.03	Sch5	2.11	-
		Sch10	3.05	-
		Sch40	5.16	-
		Sch80	7.01	-
		Sch160	9.53	-
3	88.9	Sch5	2.11	-
		Sch10	3.05	-
		Sch40	5.49	-
		Sch80	7.62	-
		Sch160	11.13	-

公制尺寸系列

公称外径 mm	公称壁厚 in	订购规格	公称长度 m	压力额定值 psig
3	0.5	φ3mmx0.5mmx6M	6	340
	0.7	φ3mmx0.7mmx6M		560
6	1.0	φ6mmx1.0mmx6M		420
	1.5	φ6mmx1.5mmx6M		710
8	1.0	φ8mmx1.0mmx6M		310
	1.5	φ8mmx1.5mmx6M		520
10	1.0	φ10mmx1.0mmx6M		240
	1.5	φ10mmx1.5mmx6M		400
12	1.0	φ12mmx1.0mmx6M		200
	1.5	φ12mmx1.5mmx6M		330
	2.0	φ12mmx2.0mmx6M		470
16	1.0	φ16mmx1.0mmx6M		140
	1.5	φ16mmx1.5mmx6M		230
	2.0	φ16mmx2.0mmx6M		330
18	1.0	φ18mmx1.0mmx6M		120
	1.5	φ18mmx1.5mmx6M		200
	2.0	φ20mmx2.0mmx6M		290
20	2.0	φ20mmx2.0mmx6M		260
22	2.0	φ22mmx2.0mmx6M		230
25	2.0	φ25mmx2.0mmx6M		200
	2.5	φ25mmx2.5mmx6M	260	

